



# **Educating Arkansas' Workforce: Ready, Set, Go!**

CONFERENCE PROGRAM

21st Annual Conference  
October 18-20, 2009  
Hot Springs Convention Center  
Hot Springs, Arkansas

**Dr. Susan Holmes  
Board President  
AATYC**



Welcome to the Arkansas Association of Two-Year Colleges' 21<sup>st</sup> annual conference! These are exciting times for two-year colleges across the nation, and Arkansas institutions are proving to be a driving force in the state's economic development through innovative, entrepreneurial education. Partnerships and a collaborative approach to learning are reflected in our theme- "*Educating Arkansas' Workforce: Ready, Set, Go!*"

This year's conference promises to be one of our best ever. In addition to great learning opportunities, you'll find multiple opportunities to spend time relaxing with colleagues and meeting new friends. Enjoy great entertainment at the Talent Showcase, get some exercise during the Poker Run/Walk, and browse the fantastic array of items available in our Academic All-Star Auction. (And remember: every dollar you spend at the auction goes straight to our students.)

On behalf of the AATYC Board of Directors, I want to thank you for choosing this conference as part of your professional development activities. If you need information or assistance at any time during the conference, please stop by the registration desk or the AATYC booth in the exhibitor's hall. We are pleased to be of service to you!

**Dr. Ed Franklin  
Executive Director  
AATYC**



Welcome to the 21st Annual Conference of the Arkansas Association of Two-Year Colleges. The theme for this year is "*Educating Arkansas' Workforce: Ready, Set, Go!*"

There has never been a time when our two-year colleges have been more in the spotlight. If we are going to maintain our national status as an economic world leader, and if we as a state are going to compete globally, we must do things in a different way than we have in the past. Our two-year colleges must take the lead in our communities and our state to move the state forward with new ideas for programs, delivery and collaborative partnerships.

This year's conference is full of these new ideas from each of our colleges. In addition, Dr. Katherine Boswell from the Community College Policy Center will set the tone for the conference as she discusses the role of two-year colleges from a national perspective. Finally, we will have Representative Robbie Wills to present his vision for the state and the role he sees for two-year colleges.

It will be a great conference. Thank you for supporting AATYC with your attendance. We hope you learn a lot and have a wonderful time.

**AATYC Board of Directors**

Ed Franklin, Executive Director  
Susan Holmes, AATYC Board President,  
NorthWest Arkansas Community College  
Joe Campbell, AATYC Board President-Elect,  
ASU-Newport  
Steve Rook, AATYC Board Vice President,  
Rich Mountain Community College  
Allen Mooneyhan, AATYC Board Past President,  
ASU-Newport

**Presidents/Chancellors Division**

Sally Carder, Chair, National Park Community College  
Steven Murray, Chair-Elect,  
Phillips Community College of the UA  
Chris Thomason, Vice Chair, UA Community College at Hope

**Administrative and Professional Staff Division**

Billy Francis, Chair, Ouachita Technical College

Carol Gresham, Chair-Elect, ASU Mountain Home  
Blake Robertson, Vice Chair, Ouachita Technical College  
Stephanie Nichols, ASU-Beebe

**Faculty Division**

Jennifer Parks, Chair, South Arkansas Community College  
Larissa Clark, Chair-Elect, ASU-Newport  
Sherry Sanders-Gray, Vice Chair,  
Mid-South Community College

**Classified Staff Division**

Pamela Belcher, Chair,  
NorthWest Arkansas Community College  
Cindy Nesmith, Chair-Elect, Pulaski Technical College  
Nancy Dust, Vice Chair, Ozarka College

**Trustee Division**

Veronica Creer, Chair, South Arkansas Community College

## Keynote Speaker - General Session



**Dr. Katherine Boswell**  
**Director, Community**  
**College Policy Center**

Katherine Boswell is the Director of the new *Community College Policy Center* at the Academy for Educational Development (AED) of Washington D.C. The *Community College Policy Center* explores effective state policies that encourage effective and innovative community colleges, and works with state policymakers in helping them make better use of their less-than-baccalaureate institutions as part of state postsecondary education systems. The Center is a collaborative partnership between AED, Iowa State University and the Education Commission of the States. She also serves as an Initiative Consultant to the Center for Law and Social Policy (CLASP) on the Shifting Gears and Postsecondary Plus Initiatives, funded by the Joyce and Gates Foundations.

Previously, Dr. Boswell served for six years as the Project Manager and Senior Initiative Consultant for the Bridges to Opportunity Initiative funded by the Ford Foundation through the University of Texas at Austin, was a senior program officer at the Education Commission of the States in Denver, Colorado, and operated her own consulting business, Education Policy Associates.

A former college administrator, in her work Dr. Boswell has worked with community colleges and state policymakers across the country in identifying best practices and strategic policy issues at the federal, state and institutional level. She has researched and written extensively on issues related to postsecondary policies. She has a Ph.D. in educational administration from the University of Texas at Austin, a Master's degree in Intercultural Administration from the School for International Training, and a B.A. in Communications from Brigham Young University.

## Keynote Speaker - All-Star Brunch



**Representative**  
**Robbie Wills,**  
**Speaker of the House**

Representative Robbie Wills has served in the Arkansas House of Representatives since January, 2005, and is in his third and final term. He is from Conway, representing House District 46 - a part of Faulkner County.

Representative Wills is the Speaker of the House for the 87th General Assembly, which convened January 12, 2009, in regular session in Little Rock. Speaker Wills also serves as a member of the House Revenue and Taxation Committee and the House Agriculture, Forestry and Economic Development Committee. As Speaker, he also holds seats on the Arkansas Legislative Council, the Joint Budget Committee and the House Management Committee.

Mr. Wills is an attorney and businessman. He has a Bachelor's Degree from the University of Central Arkansas and a Juris Doctorate Degree from the University of Arkansas at Little Rock School of Law. Before his election to the House in 2004, Mr. Wills served as a Faulkner County Justice of the Peace.

Representative Wills and his wife, Dana, have two daughters. They attend Grace United Methodist Church in Conway.

## Conference Schedule

# 21st Annual Conference --- October 18-20, 2009 Hot Springs Convention Center, Hot Springs, Arkansas Conference Schedule

### Sunday, October 18, 2009

Noon-4 p.m. ....HSCC Hall A  
Exhibitor Registration and Move In

Noon-6 p.m. ....HSCC Hall A Foyer  
Conference Registration

3:45-5 p.m. ....Horner Hall  
Opening General Session, Entertainment by  
UA Community College at Morrilton Soundscape Singers  
*Sponsored by Lee Wayne Corporation*

5-6:15 p.m. ....HSCC Hall A  
Reception and Exhibit Hall Opening  
*Sponsored by the Arkansas Broadcasters Association*

5-6:15 p.m. ....HSCC Hall A  
Academic All-Star Auction Opens

6:15.....Dinner on your own

7:30-10 p.m. ....DeSoto Ballroom, Austin Hotel  
AATYC Talent Showcase

### Monday, October 19, 2009

6:45-8 a.m..... Poker Run/Walk  
Meet at entrance to Embassy Suites

7 a.m. ....HSCC Hall A  
Exhibit Hall & Academic All-Star Auction Open

7-8:15 a.m. ....HSCC Hall A  
Continental Breakfast  
*Sponsored by Oracle*

8 a.m. - 6 p.m. ....HSCC Hall A Foyer  
Conference Registration

8:30-9:45 a.m. ....Horner Hall  
General Session & Keynote Address -  
Dr. Katherine Boswell  
*Sponsored by the*

*Arkansas Department of Career Education*

9:45-10:25 a.m. ....HSCC Hall A  
Break with Exhibitors  
*Sponsored by Educational Systems Products*

10:30-11:20 a.m.....HSCC & Austin Hotel  
Breakout Sessions A

11:20 a.m.-1 p.m. ....Lunch on your own

### Monday, October 19, 2009

11:30 a.m.-12:30 p.m.....Embassy Suites Salon A&B  
CPI Luncheon (invitation only)

12-1 p.m. ....Exhibit Hall Closed

1-1:50 p.m. ....HSCC & Austin Hotel  
Breakout Sessions B

1-3 p.m. ....meet in front of Convention Center  
Industry Tours

1:55-2:20.....HSCC Hall A  
Break with Exhibitors

2:25-3:40 p.m. ....HSCC & Austin Hotel  
Breakout Sessions C

3:50-4:10 p.m. ....HSCC & Austin Hotel  
Division Meetings

4:15-5:15 p.m. ....HSCC & Austin Hotel  
Special Interest Sessions

4:15-7 p.m. ....HSCC Hall A  
Polls open for voting

5:15-7 p.m. ....HSCC Hall A  
Academic All-Star Auction Closes  
Exhibitor Appreciation Reception & Door Prize Drawing

7-9 p.m. ....Horner Hall  
Awards Dinner  
*Sponsored by Arkansas Capital Corporation*

9-11 p.m.....Horner Hall  
Dance

### Tuesday, October 20, 2009

8-8:50 a.m. ....HSCC & Austin Hotel  
Breakout Sessions D

9:05-9:55 a.m. ....HSCC & Austin Hotel  
Breakout Sessions E

10 a.m.-noon .....Horner Hall  
Academic All-Star Brunch  
Keynote Speaker - Representative Robbie Wills  
*Sponsored by the*

*Arkansas Department of Higher Education*

## Academic All-Star Auction

Stop by the Academic All-Star Auction booth in the Exhibit Hall. The auction is held to raise money for the endowment of the Academic All-Star Fund. During the conference, you will have an opportunity to purchase tickets for \$1 each to “bid” on some great items. To “bid,” just place your tickets in the box for the item you want. (You can place all your tickets in one box or spread them out for chances on several items.) A drawing will be held on Monday evening to determine the winners.

## AATYC Talent Showcase

On Sunday evening, we’ll have the 8th Annual AATYC Talent Showcase. Beginning at 7:30 p.m. in the Austin’s DeSoto Ballroom, talented singers, instrumentalists, small combos, comedians, dancers, and more will showcase their talents. The atmosphere is **casual and nonsmoking**. A cash bar is available. Come join in the talent showcase and the fun on Sunday evening.

## Poker Run

The 6th Annual Fun Run/Fun Walk will be held Monday morning, October 19, at 6:45 a.m. Meet in front of the Embassy Suites Hotel. The Poker Run/Walk is lots of fun. Along the route, you will receive cards at certain checkpoints. The person with the best poker hand at the end of the run/walk will win!! Prizes will be given for first, second, and third place. We will also award a plaque to the college with the most participants, AND everyone who participates in the run/walk will receive an AATYC koozie. Join us for a great time of networking and exercise.

## UA Community College at Morrilton Soundscape Singers

The University of Arkansas Community College at Morrilton Soundscape Singers will perform, under the direction of Shannah Cummings, during the opening general session and the opening reception.

## Industry Tours

### Mid America Science Museum

Andy Marquart, Executive Director, will lead a tour through the largest science museum in Arkansas, the Mid-America Science Museum. The tour will highlight various ways the Museum partners with National Park Community College including the student work study program, L.I.M.E. (Leaders in Museum Education) credit course, and other community service opportunities. The vision and mission for the museum and its role in the community will also be addressed. Participants will receive a preview of new exhibits at the Museum and have the opportunity to ask questions. Visit [www.midamericamuseum.org](http://www.midamericamuseum.org) for more information about the museum.

### Fordyce Bathhouse

A tour of the Fordyce Bathhouse will be provided free of charge by the National Park Visitor Center. The Fordyce Bathhouse has been restored to its original condition of 1915. As you tour the building, your guide will provide a historical background of the building and the Hot Springs area. The guide will explain why Hot Springs and the bathhouse was such a popular location for everyone of varying economic means.

## Breakout Sessions by Interest Area

### Breakout Sessions by Interest Area

Trying to decide which sessions to attend? This topical index is designed to help you narrow your choices to those areas that might be of special interest to you. This index is not comprehensive. In view of the breadth of the topics covered at this conference, you are encouraged to read the more detailed description of the concurrent sessions as well. Each session has been given a letter and a number for easy time reference. **Blue denotes conference sponsors and exhibitors.**

**A** Sessions: Monday, 10:30-11:20 a.m.

**B** Sessions: Monday, 1-1:50 p.m.

**C** Sessions: Monday, 2:25-3:40 p.m.  
(sponsor/exhibitor sessions end at 3:15)

**D** Sessions: Tuesday, 8-8:50 a.m.

**E** Sessions: Tuesday, 9:05-9:55 a.m.

#### General Interest

- A1** NCCER/Pearson- Contren Learning Series
- A6** Arkansas Department of Career Education- Arkansas Works with a Career Plan
- A11** Blackboard- Ensuring Student Success: Making Learning Visible
- A12** Automate Your Work Using Excel, Word, and Outlook
- A19** Presidium- Service Desk Strategies and Best Practices
- A20** Oracle- Using Technology to Transform Delivery of Learning and Manage Institutions
- A21** Alliant Data Systems- CampusKey
- A22** National Association for Community College Entrepreneurship
- B1** Wimba- Trends in Technology: Best Practices in Online Instruction
- B2** Bringing Healthy Back to Your Campus! How One Campus Shed Over 1000 Pounds!
- B4** Ready or Not? A Case Study in Emergency Operations Planning
- B6** Educational Systems Products- Increase Retention and Student Success
- B7** Stop, Collaborate and Listen: Fresh Approaches to Communication in the Two-Year College
- B11** Arkansas Capital Corporation
- B16** What's New with Bridges Out of Poverty
- B19** Curtis Stout- Interactive White Boards, Control Systems for the Classroom, and AV Rover
- B20** Harris Architecture- Get the Most from Your Architect
- B21** Arkansas Aerospace Consortium
- B22** Kuder- The Arkansas College and Career Planning System
- C1** ERJ Associates
- C6** University of Arkansas Global Campus- Access Courses from Anywhere in Arkansas
- C8** Your Footprints are Always Left Online: Cybersafety
- C10** Rich Mountain Community College Recovery: Nothing is Going to Break Our Stride
- C11** Student Financial Lab- Improving Student Success by Improving Their Financial Knowledge and Skills
- C17** Dysfunctional Leadership
- C18** Excel Lists: Know When to Hold 'Em; Know When to Fold 'Em
- C19** The Hodge Group- Fundraising Strategies

#### General Interest

- C20** Wittenberg, Delony & Davidson, Inc. Architects- Creating New Learning Environments in Higher Education
- C21** Boston Reed College- Classroom Courses for High Demand Careers
- C22** VALIC- Weathering the Storm: How to Manage the Ups and Downs of the Current Marketplace
- D14** Arkansas Academic Challenge: The Lottery Scholarship in Arkansas
- E4** Nontraditional No More: The Role of Adult Student Success in Arkansas' Future
- E5** DeClutter Me!
- E14** Legislative Panel

#### Administration, Senior Leadership, Trustees

- A6** Arkansas Department of Career Education- Arkansas Works with a Career Plan
- A11** Blackboard- Ensuring Student Success: Making Learning Visible for Academic Improvement and Accountability
- A19** Presidium- Service Desk Strategies and Best Practices
- A20** Oracle- Using Technology to Transform Delivery of Learning and Manage Institutions
- A21** Alliant Data Systems- CampusKey
- B2** Bringing Healthy Back to Your Campus! How One Campus Shed Over 1000 Pounds!
- B4** Ready or Not? A Case Study in Emergency Operations Planning
- B6** Educational Systems Products- Increase Retention and Student Success
- B7** Stop, Collaborate and Listen: Fresh Approaches to Communication in the Two-Year College
- B11** Arkansas Capital Corporation
- B20** Harris Architecture- Get the Most from Your Architect
- C10** Rich Mountain Community College Recovery: Nothing is Going to Break Our Stride
- C17** Dysfunctional Leadership
- C19** The Hodge Group- Fundraising Strategies
- C20** Wittenberg, Delony & Davidson, Inc. Architects- Creating New Learning Environments in Higher Education
- C22** VALIC- Weathering the Storm: How to Manage the Ups and Downs of the Current Marketplace
- D14** Arkansas Academic Challenge: The Lottery Scholarship in Arkansas
- E4** Nontraditional No More: The Role of Adult Student Success in Arkansas' Future
- E14** Legislative Panel

#### Career Pathways

- A17** Preparing Students for the Workforce: ASU Newport CPI's Approach
- B16** What's New with Bridges Out of Poverty
- B17** Degree Plans as a Tool for Completion
- C13** Highlights of the Career Development Facilitator Training
- D3** Providing Resources for Low Income Students
- D9** Ready! Set! GRADUATE!
- D17** Adult Learning Focused Institution (ALFI) Survey
- E16** Secrets of Successful Job Placement in Career Pathways
- E17** Networking for Success

**Student Services**

- A2** Lights, Camera, Action! Create a Student News Program on a Low Budget
- A5** Advising is More than Registration
- A6** Arkansas Department of Career Education- Arkansas Works with a Career Plan
- A7** Student Engagement and Success: Making the Most of SENSE, CCSSE, and CCFSSSE
- A11** Blackboard- Ensuring Student Success: Making Learning Visible for Academic Improvement and Accountability
- A16** Club Sports: Improving Campus Climate for Students
- A19** Presidium- Service Desk Strategies and Best Practices
- A20** Oracle- Using Technology to Transform Delivery of Learning and Manage Institutions
- A21** Alliant Data Systems- CampusKey
- B3** Advising Arkansas' Workforce
- B4** Ready or Not? A Case Study in Emergency Operations Planning
- B6** Educational Systems Products- Increase Retention and Student Success
- B13** Financial Literacy for Student Success
- B10** Academic Advising for TAA Students- Differentiating Needs of a Jobless Population
- B16** What's New with Bridges Out of Poverty
- B22** Kuder- The Arkansas College and Career Planning System
- C4** Fabulous Friday- Planning a High School Visitation Day
- C5** Disability Mentoring Day (DMD): Career Development for Students with Disabilities
- C10** Rich Mountain Community College Recovery: Nothing is Going to Break Our Stride
- C11** Student Financial Lab- Improving Student Success by Improving Their Financial Knowledge and Skills
- C12** 3,2,1... Liftoff! Implementing a Mandatory New Student Orientation Program for the Masses
- C15** Let's Go- To the Expo!
- D2** The Small Institution Environment: Challenges and Opportunities for New Student Success
- D3** Providing Resources for Low Income Students
- D6** Strategies to Improve Student Retention: No Magic Required
- D9** Ready! Set! Graduate!
- D14** Arkansas Academic Challenge: The Lottery Scholarship in Arkansas
- E3** Serving Those Who Served- NorthWest Arkansas Community College and Veteran Services
- E4** Nontraditional No More: the Role of Adult Student Success in Arkansas' Future
- E8** Career Development Facilitators
- E11** Arkansas Articulation Consortium
- E13** Strengthening Campus Community: Title III

**Technology and Distance Education**

- A11** Blackboard- Ensuring Student Success: Making Learning Visible
- A13** Successfully Developing a Distance Learning Committee
- A14** Teaching Liberal Arts Courses Online: What Would Shakespeare Think?
- A19** Presidium- Service Desk Strategies and Best Practices

- A20** Oracle- Using Technology to Transform Delivery of Learning and Manage Institutions
- A21** Alliant Data Systems- CampusKey
- B1** Wimba- Trends in Technology: Best Practices in Online Instruction
- B6** Educational Systems Products- Increase Retention and Student Success
- B9** Integrating POISE, Active Directory, and Jenzabar's Portal and LMS
- B19** Curtis Stout- Interactive White Boards, Control Systems for the Classroom, and AV Rover
- C3** Online Collaboration Using Google Tools
- C6** University of Arkansas Global Campus- Access Courses from Anywhere in Arkansas
- C8** Your Footprints are Always Left Online: Cybersafety
- D5** Web Class in the Classroom- 24/7 Access
- D12** Assessing Underprepared Learners' Success in Remedial Distance Learning Courses at a Two-Year College
- D13** Technical Education Meets Distance Learning
- E7** CSEC Arkansas: Educating the Cyber Workforce
- E9** Creating Online Hybrid Manufacturing Courses for WebCT Delivery
- E13** Strengthening Campus Community: Title III

**Faculty, Academic Support, Assessment**

- A3** The Power of Partnership Building: STEM Talent for Tomorrow's Workforce
- A4** The Classroom as Laboratory: Exposing Students to a 21st Century Workforce Culture
- A5** Advising is More Than Registration
- A6** Arkansas Department of Career Education- Arkansas Works with a Career Plan
- A7** Student Engagement and Success: Making the Most of SENSE, CCSSE, and CCFSSSE
- A8** Concurrent Enrollment Policies and Practices
- A9** Is College Algebra the Right Course for AAS Students?
- A11** Blackboard- Ensuring Student Success: Making Learning Visible
- A12** Automate Your Work Using Excel, Word, and Outlook
- B3** Advising Arkansas' Workforce
- B5** Breaking Up is Easy to Do: Chopping Lecture Up into Smaller Pieces
- B7** Stop, Collaborate and Listen: Fresh Approaches to Communication in the Two-Year College
- B12** Bridge to College Algebra
- B14** EMPACTS at the College Level and GIS Applications
- B16** What's New with Bridges Out of Poverty
- B18** Nouns & Numbers: ESL Curriculum and Statistics
- B19** Curtis Stout- Interactive White Boards, Control Systems for the Classroom, and AV Rover
- B22** Kuder- The Arkansas College and Career Planning System
- C1** ERJ Associates
- C2** Interaction and Engagement with Clickers
- C6** University of Arkansas Global Campus- Access Courses from Anywhere in Arkansas
- C14** Whose Paper is it Anyway? Using Technology to Encourage Students to Take Ownership of Their Writing

## Breakout Sessions by Interest Area and Sponsor-Exhibitor Presentations Schedule

- C21** Boston Reed College- Classroom Courses for High Demand Careers  
**D1** Substitute Teacher Training Workshop  
**D4** The Pros and Cons of Computer Assisted Algebra  
**D6** Strategies to Improve Student Retention: No Magic Required  
**D7** Preparing for the Baby Boomer Tsunami  
**D8** Defining and Positioning Contract Training for a Global Corporation  
**D10** Copyrights and the Community College  
**D11** Multiculturalism and Narrative Pedagogy- Teaching Critical Thinking and Interpretive Thinking Skills  
**D12** Assessing Underprepared Learners' Success in Remedial Distance Learning Courses at a Two-Year College  
**E1** Preparing Early Childhood Instructors with the AA-PreK  
**E2** Using Project Based Learning to Help Developmental Math Students Learn Core Concepts  
**E6** Working Smarter to Work Harder  
**E7** CSEC Arkansas: Educating the Cyber Workforce  
**E10** Reorganizing Developmental Education  
**E11** Arkansas Articulation Consortium  
**E12** Implementation Strategies for Continuous Improvement in Higher Education  
**E13** Strengthening Campus Community: Title III  
**E18** Field Trips and the Classroom

### Workforce Development, Continuing Education

- A1** NCCER/Pearson- Contren Learning Series  
**A3** The Power of Partnership Building: STEM Talent for Tomorrow's Workforce  
**A6** Arkansas Department of Career Education- Arkansas Works with a Career Plan  
**A18** Breaking From Tradition: What do You Want to Be When You Grow Up?  
**A22** National Association for Community College Entrepreneurship  
**B3** Advising Arkansas' Workforce  
**B6** Educational Systems Products- Increase Retention and Student Success  
**B8** SimWelder- Using a Computer Simulated Welder to Decrease Training Time and Costs  
**B10** Academic Advising for TAA Students- Differentiating Needs of a Jobless Population  
**B11** Arkansas Capital Corporation  
**B21** Arkansas Aerospace Consortium  
**B22** Kuder- The Arkansas College and Career Planning System  
**C6** University of Arkansas Global Campus- Access Courses from Anywhere in Arkansas  
**C7** Food Safety- Everyone's Business  
**C16** Greening the World of Work  
**C20** Wittenberg, Deloney & Davidson, Inc. Architects- Creating New Learning Environments in Higher Education  
**C21** Boston Reed College- Classroom Courses for High Demand Careers  
**D7** Preparing for the Baby Boomer Tsunami  
**D8** Defining and Positioning Contract Training for a Global Corporation  
**D9** Ready! Set! GRADUATE!  
**D13** Technical Education Meets Distance Learning

- E7** CSEC Arkansas: Educating the Cyber Workforce  
**E8** Career Development Facilitators  
**E9** Creating Online Hybrid Manufacturing Courses for WebCT delivery

### Development, Public Relations

- A15** Reaching Today's Student Through Modern Technology  
**B15** Raising Dollars Creatively  
**C15** Let's Go- To the Expo!  
**C19** The Hodge Group- Fundraising Strategies  
**D15** Development /Public Relations Roundtable  
**E15** Purchasing and Publishing Demystified

### Administrative Staff

- A12** Automate Your Work Using Excel, Word, and Outlook  
**B2** Bringing Healthy Back to Your Campus! How One Campus Shed Over 1000 Pounds!  
**B7** Stop, Collaborate, and Listen: Fresh Approaches to Communication in the Two-Year College  
**C8** Your Footprints are Always Left Online: Cybersafety  
**C17** Dysfunctional Leadership  
**C18** Excel Lists: Know When to Hold 'Em; Know When to Fold 'Em  
**C22** VALIC- Weathering the Storm: How to Manage the Ups and Downs of the Current Marketplace  
**E5** DeClutter Me!

### Sponsor - Exhibitor Presentations Monday, October 19, 2009

**10:30 a.m. - 11:20**

NCCER/Pearson .....	101
Arkansas Dept. of Career Education.....	201
Blackboard.....	206
Presidium.....	B1
Oracle.....	B2
Alliant Data Systems: Campuskey.....	B3
National Assoc. for Comm. College Entrepreneurship.....	B4

**1:00 p.m. - 1:50 p.m.**

Wimba.....	101
Educational Systems Products.....	201
Arkansas Capital Corporation.....	206
Curtis Stout.....	B1
Harris Architecture.....	B2
Arkansas Aerospace Consortium.....	B3
Kuder.....	B4

**2:25 p.m. - 3:15 p.m.**

ERJ Associates.....	101
University of Arkansas Global Campus.....	201
Student Financial Lab.....	206
The Hodge Group.....	B1
Wittenberg, Delony & Davidson, Inc. Architects.....	B2
Boston Reed College.....	B3
VALIC.....	B4



**Sunday, October 18, 2009**

Noon-4 p.m. ....HSCC Hall A  
Exhibitor Registration and Move In

Noon-6 p.m. ....HSCC Hall A Foyer  
Conference Registration

3:45-5 p.m. ....Horner Hall  
Opening General Session, Entertainment by  
UA Community College at Morrilton Soundscape Singers  
*Sponsored by Lee Wayne Corporation*

5-6:15 p.m. ....HSCC Hall A  
Sunday Reception & Exhibit Hall Opening  
*Sponsored by the  
Arkansas Broadcasters Association*

5-6:15 p.m. ....HSCC Hall A  
Academic All-Star Auction Opens

6:15 p.m.....Dinner on your own

7:30-10 p.m. ....DeSoto Ballroom, Austin Hotel  
AATYC Talent Showcase

**Monday, October 19, 2009**

6:45-8 a.m..... Poker Run/Walk  
Meet at entrance to Embassy Suites - see page 5 for details

7 a.m. ....HSCC Hall A  
Exhibit Hall & Academic All-Star Auction Open

7-8:15 a.m. ....HSCC Hall A  
Continental Breakfast with Exhibitors  
*Sponsored by Oracle*

8 a.m. - 6 p.m. ....HSCC Hall A Foyer  
Conference Registration

8:30-9:45 a.m. ....Horner Hall  
General Session & Keynote Address- Dr. Katherine Boswell  
*Sponsored by the  
Arkansas Department of Career Education*

9:45-10:25 a.m. ....HSCC Hall A  
Break with Exhibitors  
*Sponsored by Educational Systems Products*

**10:30-11:20 a.m....HSCC & Austin Hotel**

**A1** **NCCER/Pearson** **101**

William Underwood, NCCER/Pearson

The National Center for Construction Education and Research (NCCER) and its Contren® Learning Series offers students the opportunity to earn industry-recognized credentials and certifications while establishing a direct link between Education and the Construction Industry. NCCER's nationally standardized training process and curricula accelerate your students' career paths into the workforce through industry-based certifications, ensuring national portability of skills. Attend this session to learn more about the current state of the Construction Industry and its future, our program offerings, current industry best practices for instructional delivery and more!

**A2** **Lights, Camera, Action! Create a Student News Program on a Low Budget** **102**

Lennon Parker, PTC

Need to get the word out about student deadlines, an event on campus, or market your course programs? PTC earlier this year established "PTCTV" a monthly news program that features student anchors and reporters that is broadcast monthly on campus monitors and on the college website, YouTube, Facebook, and Myspace. This session will show you the tools you need to get a student news program started at your college on a low budget.

**A3** **The Power of Partnership Building: STEM Talent for Tomorrow's Workforce** **103**

Dianne Langford, MSCC; Alberta Coleman, EACC; Julie Goings, PCCUA; Angie Dixon, ANC; Stacy Hagler, UAFS

Four community colleges and a university 300 miles away have joined together in the Arkansas Delta Science Technology, Engineering, and Mathematics Expansion Project (ADSTEP). Supported by funding from the National Science Foundation (NSF), the project initiatives promote STEM educational/career pathways. Methods for recruitment and retention of students will be shared.

**A4** **The Classroom as Laboratory: Exposing Students to a 21st Century Workforce Culture** **104**

Scott Simpson, ANC

This session will cover strategies for transforming our classrooms into laboratories for workforce culture training. Together, we will identify effective ways to instill a core set of values, beliefs, and habits into our students so that they are truly ready to compete in today's economy.

## Conference Schedule and Breakout Sessions A

10:30-11:20 a.m.....HSCC & Austin Hotel 10:30-11:20 a.m.....HSCC & Austin Hotel

- A5** **105** **Advising is More than Registration**  
Joanna Fulbright and Michael Orf, Ozarka
- As retention has become a buzz word in higher education, advising has become an area of interest. Research has shown that students who feel connected to the institution or an individual are more likely to be retained. This session will provide insight into the idea that advising is something that happens throughout the year and is proactive. The presenters will provide information on changing the advising habits at their institution.
- A6** **201** **Arkansas Department of Career Education**  
John Davidson and Sandra Porter, Arkansas Dept. of Career Education
- ArkansasWorks with a Career Plan: The ArkansasWorks Career Planning web-based system which offers innovative and comprehensive educational and career planning for all levels of involvement and for Arkansans of all ages – elementary, secondary and postsecondary education, parents, job seekers and employers. Kuder Navigator (secondary) and Kuder Journey (postsecondary and adult) will be the primary focus of this session.
- A7** **202** **Student Engagement and Success: Making the Most of SENSE, CCSSE, and CCFSSSE**  
Debbie Hardy, PCCUA
- This session will share how PCCUA is using data to integrate outcomes into strategic planning based upon results from SENSE (Survey of Entering Student Engagement), CCSSE (Community College Survey of Student Engagement) and CCFSSSE (Community College Faculty Survey of Student Engagement).
- A8** **203** **Concurrent Enrollment Policies and Practices**  
Dr. Karen Wheeler, ADHE
- Some support concurrent enrollment while others don't. Does it have an impact on future student success? How will state laws and policies impact current institutional practices? What are the statewide goals for concurrent enrollment, and what are the institutional roles in achieving those goals? Come hear the latest developments and have your questions ready.
- A9** **204** **Is College Algebra the Right Course for AAS Students?**  
Tracy Vaughan and Pamela Duck, NWACC
- The passage of ACT 1197 allows state-supported institutions to change the math requirement for associate of applied science degrees to "an applicable and appropriate non remedial math course." At NWACC, the Math Department, with input from the applied science areas, developed a mathematics course to better serve the needs of these students and their future employers. This session will cover the basics of the course including development, content, and various methods of delivery.
- A10** **205** **HELI Orientation**  
Dr. Linda Beene Ballard, University of Arkansas Global Campus
- For HELI students only- orientation for those registered for the upcoming Higher Education Leadership Institute.
- A11** **206** **Blackboard, Inc.**  
John Floyd and Donna Jones, Blackboard
- Ensuring Student Success: Making Learning Visible for Academic Improvement and Accountability in Community Colleges. Billions of dollars of funding will soon be available to community colleges to provide basic job skills to Americans. One certain caveat in receiving this funding is that institutions must track and report student learning outcomes, employment-related outcomes and targets. Blackboard can help make learning visible through accountability and outcomes measurement, ultimately helping your institution improve retention and graduation rates, mastery of core skills, institutional assessment projects, and student satisfaction rates. This session will provide you with an overview of how Blackboard can assist your institution with a full accountability solution for continuous improvement and assessment.
- A12** **207** **Automate Your Work Using Excel, Word, and Outlook**  
Alan Mesko, NPCC
- Opening example: Enter student grades, then email students individual reports of all grades to date and their current average. (No more questions like "What's my grade now?" and "What do I need on the final to pass?") Then Q & A will help you spend less time on your particular repetitive tasks.
- A13** **208** **Successfully Developing a Working Distance Learning Committee**  
Carolyn Alexander, PCCUA
- Do you have communication issues among faculty, administrators, IT, and staff regarding distance learning? The presenter will share how PCCUA established a Distance Learning committee, developed a strategic plan, resolved and continues to resolve distance learning issues effectively.
- A14** **209** **Teaching Liberal Arts Courses Online: What Would Shakespeare Think?**  
Jillian Hartley, Julie Pierce, and Bonnie Nichols, ANC
- The presenters will discuss different strategies and approaches to teaching liberal arts courses online. They will cover a variety of topics including discussion boards, online assignments, plagiarism, retention, and copyright infringement. Attendees should expect an open discussion of issues that both challenge and benefit the online liberal arts instructor.

10:30-11:20 a.m.....HSCC & Austin Hotel

A15 **Mt. Tower (Austin)**

**Reaching Today's Student Through Modern Technology**

Natalie Ghidotti, Ghidotti Communications

How to reach students who do not listen to traditional mass media outlets (radio, newspapers, and magazines.) Is Facebook, Twitter and text messaging our only hope?

A16 **Pageant (Austin)**

**Club Sports: Improving Campus Climate for Students**

Gene Whitley, PTC; Kenny Rayl, National Club Baseball Association

Unlike college-supported athletics governed by the NCAA, club sports teams are student organizations responsible for their own financial support and operations. This fall PTC's first club athletic team, the PTC Diamonds, played its first intercollegiate baseball games. In this session, we'll discuss the experiences we've had starting a club sports team and provide information for other institutions interested in improving the campus climate by establishing similar programs.

A17 **Tri-Lakes (Austin)**

**Preparing Students for the Workforce: ASU Newport/CPI's Approach**

Jeanette Youngblood, ASUN CPI

Preparing students to successfully enter and retain in the workforce is a major goal of the ASUN Career Pathways Initiative and is accomplished through our employability skills training program. Session participants will be introduced to numerous software programs and outside resources ASUN/CPI has integrated into our comprehensive employability curriculum.

A18 **Board Room (Austin)**

**Breaking From Tradition: What do You Want to Be When You Grow Up?**

Cindy Lance, Casey Curtis, Laura Massey, and Brent Talley, UACCH

Are your Career Technical Education (CTE) programs measuring up to the state targets set for gender and nontraditional participation? UACCH personnel discuss Perkins approved activities designed to improve student enrollment in CTE areas traditionally dominated by one gender or the other.

A19 **Hall B1**

**Presidium, Inc.**

Michael Betnun, Presidium

Service Desk Strategies and Best Practices. Presidium's mission is to provide comprehensive service-desk solutions to ensure consistent, 24/7, world-class services throughout the student experience. Education Services Management (ESM) is our methodology for implementing a "service desk" strategy for education providers. We will be discussing this methodology as well as best practices for service and support. We will highlight community colleges that have focused their efforts on service and support and the results they saw.

10:30-11:20 a.m.....HSCC & Austin Hotel

A20 **Hall B2**

**Oracle**

Blake Butler, NPCC

Hear how National Park Community College is using technology to transform the way it delivers learning and manages its institutions. Learn how they evaluated the problems they needed to overcome and how they chose their path to success. See how they have been able to drive the implementation to achieve their strategic goals.

A21 **Hall B3**

**Alliant Data Systems, Inc.**

Mandy Lanier, Alliant Data Systems

CampusKey: Accuracy, reliability and security are the cornerstone of any effective administration system. Those are the hallmarks of CampusKey, the comprehensive ERP system available from Alliant Data Systems, Inc. CampusKey offers fully integrated student and business office modules for two and four-year colleges and technical schools. With more than 100 years of cumulative experience in the higher education market, CampusKey support and development staff brings an extensive knowledge and understanding of the day-to-day operation. So make plans to come see why CampusKey should be your software solution.

A22 **Hall B4**

**National Association for Community College Entrepreneurship (NACCE)**

Tim Cornelius, NWACC; Scott Swanson, NAC; Dr. Augusta Farver, PTC; Maria Parker, CCCUA

Information about the AATYC Entrepreneurship Training Consortium and the National Association for Community College Entrepreneurship (NACCE).

**11:20 a.m.-1 p.m. ....Lunch on your own**

**11:30 a.m.-12:30 p.m. ....CPI Luncheon**

**Embassy Suites Salons A&B**

**Invitation Only**

**1-3 p.m.....Industry Tours**

**meet in lobby of Convention Center**

**(downstairs from registration desk)**

## Conference Schedule and Breakout Sessions B

**1-1:50 p.m. .... HSCC & Austin Hotel**  
**B1** **101**

### Wimba

Shelley Constant, Wimba

Trends in Education and Technology: Best Practices in Online Instruction. The Wimba Collaboration Suite helps people connect by combining interactive technologies such as voice, video, podcasting, instant messaging, application sharing, polling and whiteboarding. Our collaboration technologies empower universities and colleges to build community and engage 21st century learners, increase student-teacher & student-student engagement, bring services online, and more.

**B2** **102**  
**Bringing Healthy Back to Your Campus! How One Campus Shed Over 1000 Pounds!**

Janet Brewer, NPCC

What if a college could have a direct impact on healthcare costs while improving employee's health, morale, and teamwork? That is exactly what NPCC did with their wellness program. The college has seen a reduction in insurance loss ratio, and employees are healthier and happier. Hailed by the local newspaper as "an example for all Arkansans," NPCC is proud to share its amazing journey to health.

**B3** **103**  
**Advising Arkansas' Workforce**

Karen Hopper and Roz Blagg, ASUMH

ASUMH's Associate Vice Chancellor for Enrollment Management, Roz Blagg, and Karen Hopper, Associate Vice Chancellor for Research, Special Projects, and Distance Learning, partner to offer tips and resources for those seeking to offer outstanding advising to their students.

**B4** **104**  
**Ready or Not? A Case Study in Emergency Operations Planning**  
Carol Langston, PTC; Jeffrey Hescocock, Senior Consultant, Beck Disaster Recovery, Inc.

Colleges and universities cannot prevent natural disasters or man-made emergencies, but they can minimize the damage- if they are prepared. Find out about PTC's campus wide approach to developing a comprehensive emergency operations plan that established policies, procedures, and an organizational structure for responding to emergency situations.

**B5** **105**  
**Breaking Up is Easy to Do: Chopping Lecture Up into Smaller Pieces**

Eddie Dry, ASUMH

Research has shown that student attention spans are not as long as lecture periods tend to be. Session attendees will hear strategies used in class that engage students in activities, some of them silly, that get them up and moving around while presenting some basic biological ideas. These are methods used to break long lecture periods into smaller pieces.

**1-1:50 p.m. .... HSCC & Austin Hotel**  
**B6** **201**

### Educational Systems Products

Randy Thomas, ESP

Increase Retention and Student Success: How North Arkansas College is Making It Happen. Struggling with how your data can help increase retention and student success? With increased accountability at the federal, regional, state and local level, how will your school keep up with data demands? We will discuss NorthArk's decision to choose Educational Systems Products partner, ZogoTech, to complement their existing ERP system, POISE. We will share best practices, discuss data challenges, and more.

**B7** **202**  
**Stop, Collaborate, and Listen: Fresh Approaches to Communication in the Two-Year College**

Elizabeth Reeves, PTC

Because colleges are interdependent organizations, good communication is integral to working smarter, not harder. We'll show you how the registrar's office at PTC improved communication between our department and academic divisions utilizing modern organizational management strategies that you too can use.

**B8** **203**  
**SimWelder- Using a Computer Simulated Welder to Decrease Training Time and Costs**

Randall Sanders, Charlie Scoggins, Eddie Thomas, and Paul Patton, UACCH; Cathy Loe, CMC Joist and Deck

How the Welding Technology Department at UACCH leveraged Perkins funds and a partnership with CMC Joist and Deck Company to purchase a computer simulator that allows Welding Program students and CMC employees develop their skills in stick and MIG welding at substantially reduced costs in materials and time.

**B9** **204**  
**Integrating POISE, Active Directory, and Jenzabar's Portal and LMS**

Tamya Stallings, ASUN

Benefit from ASUN's experience with tips and tricks for integrating POISE and Active Directory with Jenzabar's Portal and LMS from installation to teaching courses online.

**B10** **205**  
**Academic Advising for TAA Students- Differentiating Needs of a Jobless Population**

Kate Louton, NWACC

The numbers of returning students due to current economic conditions is climbing. The state of Arkansas is a participant in the Trade Adjustment Act or TAA. A strong advisement system, consistency with paperwork, and academic assistance has lead NWACC to develop a program that has an 85% completion rate.

**B11** **206**  
**Arkansas Capital Corporation**  
Michelle Stockman, Arkansas Capitol Corporation

With cash prizes totaling \$194,000, the Donald W. Reynolds Governor's Cup is the premiere statewide business plan competition for college students. Two-year college students competed for the

**1-1:50 p.m.....HSCC & Austin Hotel**

first time in 2009, and a North Arkansas College team made it to the finals. Come learn about the Arkansas Economic Acceleration Foundation and this exciting competition.

**B12** **207**

**Bridge to College Algebra**

Christy Wilson, SACC; Tom Simmons, El Dorado School District; Lila Phillips and Alice Mahony, El Dorado Education Foundation

Bridge to College Algebra, a summer course designed to prepare El Dorado Promise students for College Algebra, was created through a partnership between South Arkansas Community College, the El Dorado School District, and the El Dorado Education Foundation. Program support is provided by a yearly \$15,000 community grant.

**B13** **208**

**Financial Literacy for Student Success**

Monica Quattlebaum, PCCUA

PCCUA recently developed a student success course which includes a face-to-face and an online financial literacy module. This course was developed as a result of financial literacy being identified as a major barrier to student retention and success. This presentation will provide course topics, classroom activities, and a demonstration of the online component.

**B14** **209**

**EMPACTS at the College Level and GIS Applications**

Paul Lowery, NWACC

GIS faculty at NWACC present how the EMPACTS model is used to enhance learning of course curriculum in college level science courses. Several NWACC courses utilize geospatial technology as a part of, or enhancement to, curriculum.

**B15** **Mt. Tower (Austin)**

**Raising Dollars Creatively**

Carol Gresham, ASUMH

How to attract attention for your annual fund among competition and a slow economy.

**B16** **Pageant (Austin)**

**What's New with Bridges Out of Poverty**

Claudia Griffin, UACCH CPI

Understanding and Engaging Under-Resourced College Students is a powerful tool for improving retention and graduation rates of students from poverty. An overview of the first book of its kind to provide a comprehensive look at both the needs of under-resourced students and strategies for their success. Have an Aha! Moment and win the door prize, the BOOK.

**B17** **Tri-Lakes (Austin)**

**Degree Plans as a Tool for Completion**

Tom Baker, BRTC CPI; Jo Keegan, PTC CPI

Two CPI campuses earned together a cool \$66,000 in incentive funds for students who attained associate degrees. Their plan included counseling with degree plans to put students on track. These presenters will share long-term success strategies for students with short-term goals that is used at their campuses.

**1-1:50 p.m.....HSCC & Austin Hotel**

**B18** **Board Room (Austin)**

**Nouns & Numbers: ESL Curriculum and Statistics**

Gloria Mallow and Laura Cates, NWACC

Non-native speakers have more than linguistic challenges in higher education. They typically need guidance to successfully navigate the educational system and understand expectations of future employers. Attendees will learn about cultural differences, receive handouts for classroom activities, and get relevant statistics.

**B19** **Hall B1**

**Curtis Stout**

Tonya Everhart, Curtis Stout

Interactive White Boards Technology, Control Systems for the classroom, and an all-in-one presentation cart (AV Rover). Interactive White Boards: Operate any software that is loaded onto the connected PC; Capture notes written on a whiteboard; Control the PC, markup and translate cursive writing to text. Control Systems for the classroom: Use DVDs, document cameras, internet, streaming media and PC applications; Control the AV equipment, lights, drapes and screens. AV Rover: The reliability of a ceiling mounted projector and the advantages of a portable system.

**B20** **Hall B2**

**Harris Architecture Company**

Rico Harris, Harris Architecture

Colleges need buildings. Architects design buildings. This makes for a happy, mutually beneficial relationship – right? Well, has anyone on campus mentioned “architect” and “great service” in the same sentence lately? Think your school is getting all it should from its architect? Architecture has the power to affect our emotions, to excite, encourage, and inspire. Architecture can – and should - encourage learning. Architecture can be ingenious, beautiful, dynamic, and even revolutionary. But it should also be cost-effective, functional, versatile, and relevant.....and your architect can be your ally in getting it all for your students.

**B21** **Hall B3**

**AATYC Aerospace Consortium**

Stephen Paull, UACCB

1) Overview of the development and growth of the Arkansas Aerospace Training Consortium. 2) Synergy achieved from the effective partnerships. 3) Regional markets and employment opportunities for graduates even in the down economy. 4) Proposed High School distance learning program.

**B22** **Hall B4**

**KUDER, INC.**

Ruth Brown, Kuder

The Arkansas College and Career Planning System: Educating Arkansas' Workforce Since 2002. Educating Arkansas' workforce, those who are employed now, and those who are enrolled in schools today, have the best resource possible: the Arkansas College and Career Planning System (Arkansas Works). This career development tool offers a wide array of information and resources for self discovery, career exploration, research, job searching, etc.

## Conference Schedule and Breakout Session C

1:55-2:20 p.m.....HSCC Hall A      2:25-3:40 p.m.....HSCC & Austin Hotel

**Break with Exhibitors**

2:25-3:40 p.m.....HSCC & Austin Hotel

(Sponsor/Exhibitor sessions end at 3:15.)

- |  |   |
|--|---|
| <p><b>C1</b> <span style="float: right;"><b>101</b></span></p> <p style="text-align: center;"><b>ERJ ASSOCIATES</b></p> <p>Randall Jennings, ERJ Associates</p> <p>Our presentation will feature the <i>Reading Plus</i> program, designed to help students achieve significant improvements in both reading levels and fluency rates. This unique program is used effectively in colleges around the country, yielding four to five level gains and increases in rates of 100-200 wpm in one year. In recognition of its field research and design, <i>Reading Plus</i> was honored earlier this year with the SIIA 2009 CODIE Award for “Best Post-Secondary Instructional Solution”. Come find out why!</p> | <p><b>C6</b> <span style="float: right;"><b>201</b></span></p> <p style="text-align: center;"><b>University of Arkansas Global Campus</b></p> <p>Dr. Linda Beene Ballard, UA Global Campus</p> <p>The Global Campus and its state-of-the-art technology allow students located anywhere in Arkansas and around the world to access courses taught by highly regarded University of Arkansas faculty members. Through the use of innovative learning solutions – including web-streaming, video and satellite transmission, and web-based delivery – students are provided with positive educational experiences consistent with those of a traditional learning environment. Through virtual education, students bound by personal obligations or choices that prevent their on-campus participation can earn a degree from the University of Arkansas.</p> |
| <p><b>C2</b> <span style="float: right;"><b>102</b></span></p> <p style="text-align: center;"><b>Interaction and Engagement with Clickers</b></p> <p>Bryan Aguiar, NWACC</p> <p>Student response systems (SRS), audience response systems (ARS), personal response systems (PRS), “clickers” offer one way to employ active learning in the classroom. Participants will discuss best practices in using clickers in the classroom and will use clickers to respond during the session.</p>  | <p><b>C7</b> <span style="float: right;"><b>202</b></span></p> <p style="text-align: center;"><b>Food Safety- Everyone's Business</b></p> <p>Renee Smith, PTC</p> <p>ServSafe offers high quality training options in the classroom or online in a variety of languages. Nationally recognized and accredited, more than 3 million ServSafe Food Protection manager certifications have been awarded. Discover the food safety training program that is truly “workforce ready.”</p>  |
| <p><b>C3</b> <span style="float: right;"><b>103</b></span></p> <p style="text-align: center;"><b>Online Collaboration Using Google Tools</b></p> <p>Nancy Bailey and Dave Phillips, UACCH</p> <p>This session will provide an overview of free Google Tools that can be used for online collaboration by instructors and students. Find out how to upload documents that can be edited by multiple users at the same time, how to access dependable research papers with Google Scholar, and much more.</p>  | <p><b>C8</b> <span style="float: right;"><b>203</b></span></p> <p style="text-align: center;"><b>Your Footprints are Always Left Online: Cybersafety</b></p> <p>Lennon Parker, PTC</p> <p>You don't have to be a computer whiz to be cyber safe! Learn how to be safe online as we discuss and critique online identities, emails, chatrooms, instant messaging, online journals, blogging, Myspace, Facebook, cyber bullying, shopping online and most importantly, how to uncover internet fraud for free.</p>  |
| <p><b>C4</b> <span style="float: right;"><b>104</b></span></p> <p style="text-align: center;"><b>Fabulous Friday - Planning a High School Visitation Day</b></p> <p>Tenita Shannon-Gragg, SEARK</p> <p>If you are looking for new and innovative ways to reach and recruit students, why don't you host a Fabulous Friday. Fabulous Friday allows you to invite high school students from your service area high schools to your campus. Learn best practices, ideas, lessons learned that can help you plan a totally Fabulous event.</p>   | <p><b>C9</b> <span style="float: right;"><b>204</b></span></p> <p style="text-align: center;"><b>Active Learning... YES YOU CAN!</b></p> <p>Holly Ayers and Jenny Miller, Ozarka</p> <p>Are you currently the “Sage on the Stage?” This high energy, hands-on workshop will focus on simple techniques that you can use to engage your students. As active participants in the learning process you will leave this session with the tools you need to utilize active learning strategies in every discipline, every classroom, and with every student.</p>   |
| <p><b>C5</b> <span style="float: right;"><b>105</b></span></p> <p style="text-align: center;"><b>Disability Mentoring Day: Career Development for Students with Disabilities</b></p> <p>Doris Pierce, PTC</p> <p>Disability Mentoring Day (DMD) is a day when students with disabilities shadow workplace mentors. DMD is sponsored nationally and internationally by the American Association for People with Disabilities (AAPD) and can encourage students with disabilities to get a glimpse of the world of work from their perspectives.</p>   | <p><b>C10</b> <span style="float: right;"><b>205</b></span></p> <p style="text-align: center;"><b>Rich Mountain Community College Recovery: Nothing is Going to Break Our Stride</b></p> <p>Dr. Wayne Hatcher, Brenda Gillogly, and Phillip Wilson, RMCC</p> <p>On April 9, 2009, an EF3 tornado cut a path through the most populated parts of Mena, Arkansas. RMCC took a direct hit damaging all campus buildings. Of the 70 employees, over 20 received damage to or lost their homes. This session will show participants how RMCC recovered enough to finish the spring semester and progressed to a record enrollment for Fall 2009. It is a story of hard work, dedication, and caring.</p>   |

2:25-3:40 p.m.....HSCC & Austin Hotel

2:25-3:40 p.m.....HSCC & Austin Hotel

C11 206

**Student Financial Lab**

Chris Canedy, Student Financial Lab

Improving Student Success By Improving Their Financial Knowledge and Skills. Community college students are commencing their college years with inadequate skills related to the fundamentals of managing their finances. The Student Financial Lab was developed to improve the basic financial knowledge of college students, and to provide them with tools that forge new behaviors resulting in more effective management of their money, debt and utilization of credit. The Student Financial Lab carries a nominal fee, is easily integrated and provides colleges with online program monitoring tools that minimize costs related to providing the program.

C12 207

**3,2,1... Liftoff! Implementing a Mandatory New Student Orientation Program for the Masses**

Jason Henry, Lisa Fisher, and Jasmine Ray, PTC

PTC recently launched its mandatory new student orientation. All first time entering students (approximately 1,500) were required to attend orientation before they could be advised and registered. This session will outline the process and give other two-year colleges ideas for implementing their own orientation program.

C13 208

**Highlights of the Career Development Facilitator Training**

Kyla Pirani, ADHE CPI; Rebecca Martin, NAC CPI; Amber Holloway, NWACC CPI; Miranda Rios-Blanchard, UACCM CPI; Stephanie Ellis, UACCM CPI; Michelle Supratman, ASUB CPI; Amber Milwee, ASUN CPI

EACC, NWACC, ASUB, NAC, ASUN, UACCM-ADHE/CPI offered seven scholarships to CPI employability coordinators and provided Career Development Facilitator (CDF) training. These “diligent CPI students” from the first CDF training will share lessons learned in this session.

C14 209

**Whose Paper is it Anyway? Using Technology to Encourage Students to Take Ownership of Their Writing**

Donna Hill, OTC

This presentation will discuss two online technologies, Smarthinking Tutoring Services and ETS Criterion, which can help students take ownership of their writing by teaching them how to personally examine their writing to find areas for improvement not only in grammar and mechanics, but content and style as well.

C15 **Mt. Tower (Austin)**

**Let's Go - To the Expo!**

Micki Somers and Charla Jennings, NAC

No budget, no time, no problem! The NorthArk Expo is a “college night” event showcasing NorthArk’s programs and services. Over 48 booths, along with food and prizes made the event a success. Join us to get the tools and ideas for hosting an Expo at your college.

C16 **Pageant (Austin)**

**Greening the World of Work**

Mary Ann Shope, PTC Heart of Arkansas Regional Training Consortium

Learn which traditionally “green” jobs will become high demand and which jobs, not thought of as “green,” can be made green through the addition of extra training, and where we can expect new jobs in the “green” future. Discuss the implications of the green economy on community colleges in Arkansas.

C17 **Tri-Lakes (Austin)**

**Dysfunctional Leadership**

Deltha Shell, Ozarka

Leadership isn’t just black and white. This presentation discusses various types of leadership styles through observation of action and personality. While the stereotypical tyrant leader is introduced, other characteristics such as incompetence, passive-aggressiveness and dependency also lead to dysfunctional leadership styles.

C18 **Board Room (Austin)**

**Excel Lists: Know When to Hold 'Em; Know When to Fold 'Em**

Allan Mesko, NPCC

Manage your Excel lists more effectively with multiple sorts, nested subtotals, and reuseable custom filters. Understand when and why Excel lists become unmanageable. See how to convert a list into multiple access tables (and you won’t have to re-key any data!).

C19 **Hall B1**

**THE HODGE GROUP**

Russ Hodge, The Hodge Group

What works here? Russ Hodge will review the fundraising strategies and tactics that work in most philanthropic environments and how these are best applied to the philanthropic community in Northwest Arkansas.

C20 **Hall B2**

**Wittenberg, Delony & Davidson, Inc. Architects**

Bradley Chilcote and Richard Alderman, WD&D

Creating New Learning Environments in Higher Education: How Technology Will Bring New Educational Opportunities to Arkansas Communities. This session will discuss the global marketplace for workforce training and its effect on Arkansas. Then it will discuss the impact these trends and emerging technology have upon learning within a typical classroom environment. Finally, the session will discuss the importance of flexibility in educational facility design and mobility for expensive and highly specialized vocational laboratories that can be shared with secondary schools in order to help “future-proof” higher educational facilities.

## Conference Schedule and Breakout Sessions C

**2:25-3:40 p.m. ....HSCC & Austin Hotel**

**C21**

**Hall B3**

### **Boston Reed College**

Bev Peterson, Boston Reed College

Two-year colleges currently train 60% of allied health professionals. With growing unemployment rates and a growing need for trained allied health professionals, noncredit programs are rapidly becoming a solution to provide high-quality, fast-paced training for medical careers. Boston Reed partners with colleges in 23 states to provide in classroom courses for high-demand health careers. Learn how a partnership with Boston Reed works, how you can make sizable profits, and discover how your college may be eligible for federal stimulus funds in order to deliver training for high-demand allied health careers.

**C22**

### **VALIC**

**Hall B4**

Richard Pierce, VALIC

Weathering the Storm. How to Manage the Ups and Downs in Our Current Marketplace. What is your best approach if you are near retirement or 20 years away?

**3:50-4:10 p.m. ....HSCC & Austin Hotel**

### **Division Meetings**

Attend your division meetings for an opportunity to meet the candidates for the 2009-2010 AATYC divisional positions.

Presidents/Chancellors.....	205
Administrative and Professional Staff.....	209
Classified Staff.....	208
Faculty.....	207
Trustees.....	204

**4:15-6:30 p.m. ....HSCC Hall A**

**Polls open for voting**

**4:15-5:15 p.m. ....HSCC & Austin Hotel**

### **Special Interest Sessions**

These sessions provide an opportunity for you to meet other conference attendees with similar interests. Come to discuss, share best practices, and network!

Presidents/Chancellors.....	205
Chief Academic/Student Affairs Officers.....	102
Chief Financial Officers.....	103
Career Pathways.....	104
Information Technology.....	105
Business Education Faculty.....	201
Math Faculty.....	202
Social Science Faculty.....	203
Science Faculty.....	204
English Faculty.....	206
Distance Education Faculty.....	207
Developmental Education Faculty.....	208
Students Services.....	209
AATYC Aerospace Consortium.....	B1
WorkForce Training Consortium.....	B2
AATYC Entrepreneurship Consortium.....	B3
Cisco.....	B4
Library/Media Center.....	Board Room (Austin)
Development /Public Relations.....	Mt. Tower (Austin)
Technical Faculty.....	Pageant (Austin)
Blackboard Users Group.....	Tri-Lakes (Austin)

**5:15-7 p.m. ....HSCC Hall A**

**Exhibitor Appreciation Reception & Door Prize Drawing  
Academic All-Star Auction Closes**

**7-9 p.m. ....Horner Hall**

**Awards Dinner Honoring  
Outstanding Faculty & Staff**

*Sponsored by Arkansas Capital Corporation*

**9-11 p.m. ....Horner Hall**

**Dance**



Tuesday, October 20, 2009

8-8:50 a.m.....HSCC & Austin Hotel

D1 101

**Substitute Teacher Training Workshop**

Tenita Shannon-Gragg, SEARK

School Districts across the state are finding it harder and harder to hire and retain sufficient numbers of substitute teachers. The need for those teachers has increased due to things like mandatory in-service, staff development, and district planning. One way to solve this problem is through Substitute Teacher Certification. Using a variety of methods such as lecture/discussion, media, hands-on and group exercises, this course provides participants training in five areas.

D2 102

**The Small Institution Environment: Challenges and Opportunities for New Student Success**

Angela Blankenship and Leslie Wells, ANC

Join an interactive dialogue facilitated by colleagues from a small institution who have used the Foundations of Excellence process to improve new student success. What are the challenges and opportunities for the first year that must be addressed to improve student success? Whether or not you have participated in the FoE process, come share your perspective and experience.

D3 103

**Providing Resources for Low Income Students**

Tara Johnson, ATU Ozark CPI; Amber Holloway, NWACC CPI

Searching for resources for low-income students is a full-time and exhausting job. However, one CPI campus hosted a fair for students with all community resources in one spot (ATU-O). Another campus used incentive funds for a membership that paid off for all students (NWACC).

D4 104

**Pros and Cons of Computer Assisted Algebra**

Valerie Martin, NAC

Students are using computers in all aspects of their lives. At North Arkansas College, we have 100% of our Beginning and Intermediate Algebra courses on computers. Learn what faculty and students have experienced and about the changes made in the first four years of this program.

D5 105

**Web Class in the Classroom - 24/7 Access**

Tommy Flud, NAC

This workshop will focus on the development and implementation of a simple, inexpensive method of providing streaming video and audio lecture recordings of conventional courses to online web class students. Evidence over the past year indicates that streaming video and audio to online classes resulted in an increase in enrollment.

8-8:50 a.m.....HSCC & Austin Hotel

D6 201

**Strategies to Improve Student Retention: No Magic Required**

Larry Andrews and Brooke Burger, SACC

Although retention research and findings have been published over the past several years, there has been little change in retention rates for either four-year or two-year institutions. The objective of this presentation is to support the idea that retention strategies can be effective in increasing the number of first-time students and returning students (re-enrollment), without establishing costly, labor intensive programs.

D7 202

**Preparing for the Baby Boomer Tsunami**

Claudia Beverly, UAMS

The purpose of the Robert Wood Johnson funded grant- Partners Investing in Nursing's Future (PIN): Planning for Workforce development in geriatric and Long-Term Care is to increase the number of geriatric prepared registered nurses in nursing homes. A partnership approach will support recruiting and developing a unified educational pathway to accommodate the natural pipeline into registered nurse programs .

D8 203

**Defining and Positioning Contract Training for a Global Corporation**

Teresa Whitmire, NWACC

Contract training has evolved to global levels as companies across the world look for ways to reduce training costs and increase employee performance. Prepare to learn how to provide a customized training program through a unique network of community colleges designed to deliver superior corporate training to fit every global need.

D9 204

**Ready! Set! GRADUATE!**

Rebecca Martin and Cherie Conner, NAC CPI

How do you teach your students to be marketable in a competitive job market? Using handouts and our proven methods, you will learn how to prepare and use a professional resume and portfolio to give your students the edge and the ability to answer tough interview questions like "Why should we hire you?"

D10 205

**Copyrights and the College Community**

Daniel Page, EACC

Educating Arkansas' Workforce includes partnerships focused on the exchange of information. Understanding copyright laws as they pertain to community colleges is vital to maintaining the integrity of these relationships. This session will attempt to simplify some of the more common copyright issues and to address some myths of copyright laws in education.

## Conference Schedule and Breakout Sessions D

8-8:50 a.m.....HSCC & Austin Hotel

**D11** **206**  
**Multiculturalism and Narrative Pedagogy - Teaching Critical and Interpretive Thinking Skills**

Jimmy L. Boyd, ASUB

Many challenges face the current crises with traditional higher education including lack of qualified faculty, shifting paradigms, limited resources, and increasing diversity among faculty and students within the context of multiculturalism. One solution is the advent of Narrative Pedagogy (NP); NP provides an avenue in exploring existing pedagogies and varying learning styles to find successful reform measures that shift to learner-centered approaches.

**D12** **207**  
**Assessing Underprepared Learners' Success in Remedial Distance Learning Courses at a Two-Year College**

Diana Johnson and Jean Anderson, NWACC

Twenty-eight percent of freshmen in fall 2000 were enrolled in one or more remedial courses. Colleges are offering more remedial courses through distance education. This research study was undertaken to determine whether under prepared learners acquire the necessary skills in remedial classes offered through distance education (online).

**D13** **208**  
**Technical Education Meets Distance Learning**

Don Powell and Jim Jones, PTC

Technical Education is both knowledge and skills-based. Providing the knowledge component using distance education has not been difficult, but providing the hands-on skills-based learning in a distance education format has proven problematic. This presentation addresses how PTC is using distance education to provide both the knowledge base and skills building required in technical education courses.

**D14** **209**  
**Arkansas Academic Challenge: The Lottery Scholarship in Arkansas**

Tara Smith, ADHE

Learn the basics about the new, lottery-funded Arkansas Academic Challenge Scholarship. We will discuss scholarship eligibility for both traditional and nontraditional students, continuing eligibility requirements, and the new universal application process. Get the information you need to help students on your campus understand this important new program.

**D15** **Mt. Tower (Austin)**  
**Development/Public Relations Roundtable**

Melissa Hendricks, PTC

Roundtable discussion of best practices, questions and answers, officer elections.

8-8:50 a.m.....HSCC & Austin Hotel

**D16** **Pageant (Austin)**  
**Incorporating Patient Simulation into Nursing and Allied Health Curricula**

Terry Clausen, SEARK

This presentation is designed to explore the process and benefits of using human patient simulators in allied health education programs. Realistic patient care scenarios are used as the basis for adding hands on practice in both the theory and clinical courses. Key components of setting up and running a successful simulation program will be discussed along with opportunity to ask and receive practical experience based answers to "How To..." questions.

**D17** **Tri-Lakes (Austin)**  
**Adult Learning Focused Institution (ALFI) Survey**

Kay Bonds, MSCC CPI

Adult students at six CPI Institutions completed the Adult Learner Inventory (ALI), while faculty, administrators and staff completed the Institutional Self-Assessment Survey (ISAS). Together the two surveys comprise the Adult Learning Focused Institution (ALFI) Toolkit. Participating sites received charts detailing the perceptions of each group on the eight ALFI Principles of Effectiveness in Serving Adult Learners.

9:05-9:55 a.m.....HSCC & Austin Hotel

E1 101

**Preparing Early Childhood Instructors with the AA-Pre-K**

Trude Puckett and Jeanne Williams, PTC

The session will introduce the proposed AA-Pre-K degree based on Act 187 for the new Pre-K teaching credential. The work of the Early Childhood Higher Education Work Group will be highlighted and information will be provided concerning next steps for state-wide implementation.

E2 102

**Using Project Based Learning to Help Developmental Math Students Learn Core Concepts**

Barbara J. Radenmacher, NWACC

As many unemployed workers begin attending college, many will enroll in developmental mathematics classes. Most workers are familiar with a culture of “doing” rather than sitting. Working on relevant projects can keep them interested and motivated.

E3 103

**Serving Those Who Served- NWACC and Veteran Services**

Todd Kitchen, NWACC

Session dealing with meeting the needs of veterans returning to college.

E4 104

**Nontraditional No More: The Role of Adult Student Success in Arkansas' Future**

Dr. Karen Wheeler, ADHE

Arkansas was one of three states awarded the Non-Traditional No More: Policy Solutions for Adult Learners grant. The goal of the grant has been to increase adult learners’ access to and success in postsecondary education. This session will share the findings of several statewide work groups that focused on what characterizes an “adult friendly” campus in terms of academic affairs, student affairs, and financial aid operations.

E5 105

**DeClutter Me!**

Drexene Winey, Ozarka

Do you dread walking into your office because you know it’s a mess? Are you constantly looking for something that you know you have SOMEWHERE? Are you having thoughts of throwing everything away and starting over? This session will provide you with tips for decluttering, organization, and time management.

E6 106

**Working Smarter to Work Harder**

Renee Calhoun and Dr. Mark Cooper, UCA

Approximately 56% of Arkansas’ first-year students attending two-year institutions need remediation. How can educators teach students to “WORK SMARTER AT WORKING HARDER” to achieve the goal of a certificate or degree? This session will provide educators with research-validated teacher and student focused interventions designed to achieve measureable results for struggling students.

9:05-9:55 a.m.....HSCC & Austin Hotel

E7 201

**CSEC Arkansas: Educating the Cyber Workforce**

Dr. Sujeet Sheno, University of Tulsa

Arkansas’ two-year colleges have received an invitation to join the Cyber Security Education Consortium (CSEC) led by the University of Tulsa and the Oklahoma Career and Technology Education System. CSEC is a National Science Foundation ATE Regional Center of Excellence dedicated to building an information security workforce who will play a critical role in implementing national strategy to secure cyberspace.

E8 202

**Career Development Facilitators**

Ray Henson, Arkansas Department of Career Education

Career Development Facilitators are being trained to fill the need to better serve secondary and postsecondary students for career and education planning. Governor Mike Beebe plans to provide funding for 44 new CDF positions serving the 21 lowest socioeconomic counties as part of a three-year pilot program in the Arkansas Works initiative.

E9 203

**Creating Online Hybrid Manufacturing Courses for WebCt Delivery**

Dr. Jeff Watson, Lee Griffith, and Jack DeLoach, EACC

This presentation is an outline of the process used to convert a traditional technical program, Advanced Manufacturing Technology, into an online hybrid program with the class work delivered via the Internet and the lab work taught as traditional labs. The ADDIE instructional design model was used to create courses and support materials. The ADDIE model insured that each course and supporting materials were designed at the appropriate level for college students.

E10 204

**Reorganizing Developmental Education**

Gwendolyn McGhee and Edelma Simes, PCCUA

This session will highlight the Achieving the Dream initiative at PCCUA aimed at assisting students in successfully completing development courses, enrolling in and completing subsequent courses, and completing “gatekeeper” courses. The reorganization in developmental education has resulted in mandatory labs for all developmental reading, English and math classes.

E11 205

**Arkansas Articulation Consortium**

Tenita Shannon-Gragg, SEARK; Jerry Little, OTC

The fastest growing segment of the American economy requires 2 years or more of higher education. Many universities and colleges outside of Arkansas have recognized the need to provide inverted Bachelor degree programs to attract AAS degreed students. The Arkansas Articulation Consortium (AAC) is an innovative voice in AAS degree options for Arkansas students.

## Conference Schedule and Breakout Sessions E

**9:05-9:55 a.m.....HSCC & Austin Hotel**

**E12 207**  
**Implementation Strategies for Continuous Improvement in Higher Education**

Bruce Moses, NWACC

This presentation will define continuous improvement and reveal implementation strategies for continuous improvement for higher education institutions. The session is designed to provide principles, a management system, and teamwork tools that guide improvement of systems and processes in any higher education institution that will benefit faculty, staff, and administration.

**E13 208**  
**Strengthening Campus Community: Title III**

Sandie Melton, ASUMH

A Title III Grant to Strengthen Student Access and Success has energized the campus community of ASUMH. Faculty Professional Development and Student Success Pilot Studies are the “buzz” words on campus. Webcams, SmartBoards, learning styles, workshops, opportunities, webinars, mentors, tutors, resources, and flat screen TVs keep us busy learning how to learn.

**E14 209**  
**Legislative Panel**

Senator Shane Broadway, Senator Steve Faris, Representative Mike Burris, and Representative Johnnie Roebuck discuss the upcoming legislative session and issues affecting higher education. Come learn from the experts and have your questions answered.

**E15 Mt. Tower (Austin)**  
**Purchasing and Publishing Demystified**

Amy Green and Tim Walbert, PTC

Producing high-quality publications is a challenge by itself, but navigating the murky waters of bidding out print jobs and complying with state purchasing law can be tricky business. This session, led by two experts on the subject, will give attendees the knowledge required to do a great job and stay out of hot water.

**E16 Pageant (Austin)**  
**Secrets of Successful Job Placement in Career Pathways**

LaTaschya Harris, NPCC CPI; Mark Thomas, OTC CPI

Mark Thomas, OTC, and LaTaschya Harris, NPCC will present information on how to assist students in building pathways from college to careers. The presenters will discuss program strategies that have been successful in building partnerships with business, industry and technical programs. Workshop attendees and presenters will share career planning resources.

**E17 Tri-Lakes (Austin)**  
**Networking for Success**

LaWarn Rodger, UAM College of Technology- McGehee CPI

We all want to be successful networkers. No businessperson today can afford not to have an up-to-date service network of contacts to call upon. For the individual, it can have a massive effect on personal success and career development. In this workshop, we will focus on all aspects of networking. The workshop will look closely at 3 areas: 1) Preparation; 2) Participation; and 3) Profiting.

**9:05-9:55 a.m.....HSCC & Austin Hotel**

**E18 Board Room (Austin)**  
**Field Trips and the Classroom**

Homer Solis and Mary Moore, UACCB

Faculty should incorporate the use of field trips into student learning. This promotes faculty/student interaction and takes advantage of real world experiences with applications of theoretical concepts. Students can practice the art of networking in the field while developing specific skill sets, and learning how academic theory translates into the real world. Advantages/disadvantages as well as unique problems of student travel will be discussed.

**10 a.m.-Noon .....Horner Hall**

**Academic All-Star Brunch Honoring  
Outstanding Alumni & Academic All-Stars  
Keynote Speaker - Representative Robbie Wills  
*Sponsored by the  
Arkansas Department of Higher Education***

## Outstanding Faculty

### Arkansas Northeastern College Dr. Angela Blankenship

Dr. Angela Blankenship is a reading instructor in the College Prep division. She is an excellent teacher whose enthusiasm motivates her students to succeed. Dr. Blankenship uses innovative techniques to prepare her students for regular college classes. She has also served as the Foundations of Excellence Liaison.

### Arkansas State University-Beebe Dr. Leslie R. Battles

As the Chair of the Math/Science Division, Dr. Les Battles epitomizes the combination of compassion and efficiency that is the mark of a truly gifted administrator. His “gee willikers” manner masks his keen intellect and serves him well in his duties. Les’ life is devoted to serving the educational needs of Arkansans.

### Arkansas State University Mountain Home Jessica Clanton

Jessica Clanton began her education at a two-year college without a declared major, but an astronomy course sparked her interest in the workings of the physical world. Jessica’s interest in the wonders of our universe has translated into engaged, energized, and enlightened math and science students.

### Arkansas State University-Newport Anna Westman

Anna Westman is an English and foreign language instructor. She says, “One of the best parts about being an instructor is the chance to get to know and learn from the many students that I meet in my classroom.” Anna is also involved in Phi Theta Kappa, Culture Share, and Kids College.

### Black River Technical College Karen Liebhaber

Karen Liebhaber brought Black River Tech to the world of on-line classes when she became the Distance Education Coordinator. Her enthusiasm and friendly personality has helped her recruit faculty to this form of instruction. Karen says “Learning should be interesting, accessible, and applicable to real life.”

### Cossatot Community College of the University of Arkansas Tabetha Nguyen

Tabetha Nguyen is an instructor and coordinator for the colleges’ developmental education program. Her philosophy is that every student has worth and is capable of learning. Tabetha’s efforts have improved the number of students eligible to move from developmental to university transfer courses and degree programs.

### East Arkansas Community College Dr. Catherine Cline

Dr. Catherine Cline exhibits the skills and attributes of a distinguished teacher. She effectively facilitates discovery and learning in both developmental classes and literature courses. Dr. Cline’s teaching style is challenging, yet engaging, and she encourages her students to reach their highest potential.

### Mid-South Community College Trenia Miles

Trenia Miles’ knowledge, compassion, and experience make her the perfect person to meet the needs of new students. According to one of her coworkers, Trenia “goes the extra mile to ensure that her students are informed, engaged and enlightened.” Trenia says, “I teach because I want to make a difference in the lives of others.”

### National Park Community College Jason Armitage

Jason Armitage, an automotive teacher, passes on to his students the “why and how” of the repair process and business. He believes automotive students have often been “overlooked” and not “afforded the same chance as more academically gifted students.” Armitage reaches out to these students and gives them the necessary tools for success.

### North Arkansas College K.C. Jones

With 30 years experience, K.C. Jones has received the prestigious Lyman Long award twice for outstanding instruction in the emergency medical technician field, and he has been chosen Arkansas Instructor of the Year. K.C. says “I see students as individuals who need a spark to ignite the torch of learning.”

### NorthWest Arkansas Community College Dr. Mary Lowe

Dr. Mary Lowe is an innovative learning college instructor. Highly respected by students, faculty, and staff, she has brought national recognition to the college’s paralegal program. Dr. Lowe is a strong community advocate, speaking frequently before student and citizen groups about issues in education and the law.

### Ouachita Technical College Sherree Hughes

As a medical office administration instructor, Sherree Hughes makes it a top priority to stay in contact with employers so that her students will have jobs upon graduation. Additionally, she participates in SkillsUSA, spending untold hours after work and on weekends preparing students for competition.

## Outstanding Faculty

### **Ozarka College Joanna Fulbright**

Joanna Fulbright is an English instructor, and she currently serves as co-chair for the college's self-study. Her attention to detail and thoroughness is second to none. Joanna has a true passion for education and making a difference to the students in her classroom.

### **Phillips Community College of the University of Arkansas Monica Quattlebaum**

Monica Quattlebaum's passion for her business and information systems students shows as she challenges them to learn, excel, and achieve their goals. Monica says: "My students may forget what I taught them, but I hope they will never forget how I treated them. Teaching is very rewarding to me."

### **Pulaski Technical College Nicki Feldman**

Nicki Feldman is an inspiration to her peers and students. Her patience and guidance have helped hundreds of students excel in college-level mathematics and ultimately develop confidence in their academic abilities to succeed in college. Nicki was recently honored by her peers with the Susan K. Reid Award for Teaching Excellence.

### **Rich Mountain Community College Sandra Slaton**

Sandra Slaton began her career as a teacher. Early in her career, she realized that her passion is working with people of all ages who struggle in many areas due to deficits in reading. Sandra completed her master's degree in reading and is now a developmental reading specialist and instructor.

### **South Arkansas Community College Mary Pat Cook**

Mary Pat Cook is the Director of Education. With a good sense of humor and a ready laugh, she greets each situation with a positive attitude and a willingness to work through obstacles. Mary Pat is an outstanding example of the state's two-year college educators and their dedication to excellence and public service.

### **Southeast Arkansas College Bob Starkey**

Bob Starkey is a fine biologist and an excellent instructor of human anatomy and physiology. His record of student success suggests that he engages the students with skill and finesse. Bob consistently produces the level of student welcome in nursing and other health service programs.

### **Southern Arkansas University Tech Ricky Purifoy**

Ricky Purifoy encourages his students to obtain the skills necessary to excel as automotive technicians. His coaching and constant encouragement led his students to place in the top ten Arkansas Teams at the 2009 SkillsUSA competition. Ricky's service philosophy is: "Do your job right the first time."

### **University of Arkansas Community College at Batesville Dennis Broadwater**

As a tutoring coordinator, Dennis Broadwater organizes student tutoring, provides study skills information, and teaches strategies for college success. Dennis' goal is: "To break down barriers that prevent a student from reaching his or her educational potential." Co-workers describe Dennis as student-centered, flexible, and respected.

### **University of Arkansas Community College at Hope Staci Shupe**

Staci Shupe, a history instructor at UACCH, has excelled in the classroom and works diligently to fulfill the vision of the college. She is dedicated to helping her students succeed, and she is well respected by both her peers and the community. Staci has been teaching full time at UACCH since August 2006.

### **University of Arkansas Community College at Morrilton Nanette Berry**

Nanette Berry teaches mathematics and serves as co-chair of the college's self study. Two of her students said, "Ms. Berry's strength lies in her ability to teach all learning styles; and Ms. Berry is a well-prepared teacher whose desire for teaching shines through to others."

## Outstanding Staff

### Arkansas Northeastern College Leslie Goff Wells

Leslie Wells is Arkansas Northeastern College's Coordinator of Enrollment Services. Her creativity has fostered new activities in recruiting, orienting and advising new students. She is the Liaison for the Foundations of Excellence Program, and this year she will be a Coordinator of the First Year Experience Committee.

### Arkansas State University Beebe Becky Latting

Becky Latting is the program coordinator of concurrent enrollment. She played an integral role in securing National Association of Concurrent Enrollment Program accreditation for ASU Beebe. Becky says, "I want to provide high quality service by expressing genuine interest in students, concurrent enrollment partners and our community."

### Arkansas State University Mountain Home Richard "Rich" Jesse

Rich Jesse's interview with ASU Mountain Home in 2006 was his first in 33 years. After many years in Chicago, Rich and his wife followed family to Mountain Home. Today, he says when he looks out the windows of ASU Mountain Home he sees only beauty. According to Rich, "I work in beauty, and I work with beautiful people."

### Arkansas State University Newport Mary Houchin

Mary Houchin is the Personnel Assistant at ASU Newport Technical Center-Marked Tree. She began work at what was then Delta Vocational Technical School as a secretary in 1985. Mary says, "One of my greatest joys is helping other people. I see a job that needs to be done, and I don't mind helping in any way possible to accomplish it."

### Black River Technical College Regina Moore

Regina Moore began her career at Black River Technical College as Administrative Secretary to the Vice President of Student Services. As a recent academic all-star, Regina received a scholarship and will complete her baccalaureate degree in December. She recently accepted a new position in the Distance Education department.

### Cossatot Community College of the University of Arkansas Keith Burt

Serving as the Assistant to the Director of Student Services, Keith Burt is a behind the scenes individual. His diligence with student records provides the college with timely reports both within the institution and to the State. The entire college staff will tell you, "Contact Keith, he will know."

### East Arkansas Community College Janie Bailey

As a team player, Janie Bailey is devoted to excellence, supportive of faculty and administration, and willing to take on numerous duties outside of her job description. Her leadership and expertise in the Allied Health Sciences has helped in developing new health degrees and accreditation.

### Mid-South Community College Linda Graham

As the Ciba Technical Center Counselor, Linda Graham helps concurrent high school students pursue higher learning opportunities. According to her coworkers, Linda "truly cares about students going out of her way to help them become successful. She works tirelessly to ensure that each student has every possible advantage."

### National Park Community College David Hughes

Under David Hughes' leadership as the Associate Vice President for Technical Education, the Technology Center has grown in average from 138 students to 319 students per semester. He inspires and motivates his staff to think outside the box. His philosophy is to "always try to improve the things you touch and always take the opportunity to give something back."

### North Arkansas College Nancy Jenkins

Nancy Jenkins' philosophy is one of service. She is an integral member of the Faculty Secretaries office. She was a student at NorthArk and now gives back to the faculty who helped her achieve her dreams. Nancy's colleagues honored her with a standing ovation when she was selected for this award.

### NorthWest Arkansas Community College Steve Tosh

Steve Tosh brings the philosophy of an old-fashioned neighborhood "beat cop" to the Department of Public Safety. He makes genuine connections with students, faculty and staff through his exemplary service and willingness to help others. When watching people interact with him, it's clear Steve is well-liked and respected.

### Ouachita Technical College Lloyd Melton

Lloyd Melton has been called the silent wizard behind the scene that keeps the email flowing, the switches switching, and the routers routing. He is responsible for all data backups and all server updates. Lloyd's advocacy of "Open Source" programs have saved the college tens of thousands of dollars in equipment and licensing costs.

## Outstanding Staff

### **Ozarka College Wanda McConnaughay**

Serving as the Secretary for the Office of Admissions, Wanda McConnaughay is quick to assist students, faculty, and staff with any task, providing outstanding service and compassion with a generous spirit of volunteerism. Wanda also served as Ozarka's Academic All-Star in 2004.

### **Phillips Community College of the University of Arkansas Terry Simpson**

Eleven years ago, Terry Simpson was among the first employees hired at the Stuttgart campus of Phillips College. For three years, she was responsible for financial aid, testing and advising. Today, Terry serves as an advisor for the Stuttgart campus and is actively involved in the life of the college and in her community.

### **Pulaski Technical College Larry Lewallen**

As Pulaski Technical College's Career Links Coordinator, Larry Lewallen has advised thousands of students over the past decade of the opportunities available in technical and industrial education. Larry was nominated this year by his peers to receive the college's annual Quenton C. Burge Award, honoring excellence in service.

### **Rich Mountain Community College Lucy Jones**

Prior to joining Rich Mountain Community College, Lucy Jones taught for 11 years in Mena Public Schools. She has served 20 years at RMCC working as a TRIO coordinator and grant writer and adjunct English and developmental education faculty. Lucy has served in leadership roles at the local, state and nations levels in TRIO.

### **South Arkansas Community College Veronda Tatum**

Veronda Tatum was hired by South Arkansas Community College in 1996. She has served as Financial Aid Officer, Recruitment Coordinator, Director of Testing and Student Activities, and is now the Director of Financial Aid. Veronda is the secretary of the Arkansas Association of Women in Two-Year Colleges and is actively involved in the Employee Club.

### **Southeast Arkansas College Daytra Demmings**

Daytra Demmings performs her varied duties with extreme competence: she is accurate, conscientious, and creative. As coordinator of Distance Learning, she works with IT, faculty and students to ensure a positive experience for online courses. As Coordinator of the Carl Perkins Grant, Daytra identifies programs that improve the college's performance.

### **Southern Arkansas University Tech Ginger Everett**

Ginger Everett is a true leader for SAU Tech and the Career Pathways Initiative. Together with her department, she walked door to door in Camden's housing projects, encouraging residents to further their education. Ginger says, "I believe that providing positive support and pertinent resources for our adult learners will affect the welfare of their families and their roles in our community."

### **University of Arkansas Community College at Batesville Lea Ramsey**

Lea Ramsey is UA Community College-Batesville's database administrator. She assisted the campus with the Datatel conversion, designed work processes, developed reports, and trained users. Co-workers describe her as someone who rarely says that something can't be done. Rather, she is someone determined to do things right.

### **University of Arkansas Community College at Hope Dave Phillips**

As the Director of Telecommunications at UA Community College-Hope, Dave Phillips is no stranger to the community. He is very active in Lions Club, Relay for Life and many other boards and civic organizations. Dave donates countless hours to the community and is always willing to help with activities on campus.

### **University of Arkansas Community College at Morrilton James Eddy**

James Eddy has been employed at UA Community College-Morrilton for 20 years in the Maintenance Department. James does not relate to the words "I can't." He works very hard and is self-motivated, and he is very personable and has never met a stranger. Our description of James is—"Dedicated."



## Outstanding Alumni

### Arkansas Northeastern College Monte Hodges

Monte Hodges was selected as Arkansas Northeastern College's Outstanding Alumnus for his commitment to education and community involvement. Monte is a loan officer with Farmers Bank & Trust and a Blytheville City Council member. He is currently working on his baccalaureate degree.

### Arkansas State University-Beebe Lyndle McCurley

Lyndle McCurley says, "Attending ASU-Beebe changed the direction of my life." Lyndle has held numerous positions in community colleges throughout the country including: physical education instructor, coach, head of the athletic department, and Vice Chancellor for Administrative Affairs at ASU Mountain Home.

### Arkansas State University Mountain Home James McLean

State Representative and Funeral Director James McLean represents what ASU Mountain Home hopes for all its alumni – success in his profession. As a freshman legislator, James used his personal knowledge of the role of two-year colleges and worked relentlessly on their behalf for what became Arkansas' lottery bill.

### Arkansas State University-Newport Darlene Black

Following graduation from ASU-Newport, Darlene Black completed a baccalaureate degree in early childhood and elementary education and went on to complete a master's degree. She is currently a teacher in the Newport Special School District, and she was the 2005-2006 recipient of ASU Jonesboro's Outstanding Alumnus.

### Black River Technical College Brandi Chester

Brandi Chester, the Director of Financial Aid, began her education at Black River Technical College, completed her baccalaureate degree in business finance, and is currently pursuing a master's degree in business technology. Brandi is actively involved in financial aid awareness presentations at high schools and "College Goal Sunday."

### Cossatot Community College of the University of Arkansas Patrick Massey

As a student at Cossatot Community College of the UA, Patrick Massey worked in the college's project to assist migrant workers' children, and he was a frequent contributor to the student newspaper. As the managing editor of Sevier County's weekly newspaper, Patrick is the youngest managing editor in Arkansas.

### East Arkansas Community College Lt. Col. Evelyn Jones-Talley

Lt. Col. Evelyn Jones-Talley, U.S. Army Reserves, is the program manager for the Emergency Medical Technician-BASIC program. Awarded numerous Army achievement and commendation medals, Lt. Col. Talley was one of the first graduates from East Arkansas Community Colleges' nursing program. She also holds a baccalaureate degree in nursing and two master's degrees.

### Mid-South Community College Henry Tseng

Henry Tseng is a Mid-South Community College graduate and a critical member of the college's Information Technologies team. He has endeared himself to the college community with his outstanding technical abilities and his easy-going personality. Henry completed a baccalaureate degree in engineering and a master's degree in business administration.

### National Park Community College Forrest Spicher

Forrest Spicher is a Garland County native and graduate of National Park Community College. He received the 2009 Hot Springs Chamber of Commerce's *Man of the Year* award. With a philosophy that is based on faith, family and community, Forrest volunteers for the college's Foundation and numerous other organizations.

### North Arkansas College Judge Mike Moore

Boone County Judge Mike Moore got his start in higher education at NorthArk. "Without the opportunity to attend NorthArk, I probably never would have enrolled anywhere else," he says. A licensed minister, Judge Moore serves as associate pastor at CrossRoads Community Church. A Navy veteran, Judge Moore served in Desert Storm.

### NorthWest Arkansas Community College Rick McLeod

After graduating with an associate of science in general business, Rick McLeod earned a baccalaureate degree in business management and is currently pursuing an MBA. An Army veteran and small business owner, Rick says "My NWACC experience gave me the tools I need to help my community and to be successful in business."

## Outstanding Alumni

### Ouachita Technical College

#### David Karrer

David Karrer believes that teaching mathematics at the middle school level is his dream job. David began at Ouachita Technical College in the Adult Education Program where he received his GED with honors. After earning two associate degrees from OTC, David went on to complete his baccalaureate degree, graduating Cum Laude.

### Ozarka College Chaney Coleman

Chaney Coleman was a work-study at Ozarka College while a student, and he has been employed with the college since 2002. His work ethic, kind spirit, and technical skill have landed him in the center of the Information System Department. When colleagues have a software issue, Chaney is considered the “go-to” guy.

### Phillips Community College of the University of Arkansas Sherry Criswell

Sherry Criswell completed an associate degree from Phillips Community College of the UA and now serves as senior vice president at Arkansas County Bank in DeWitt. She is a member of the college’s Board of Visitors and is an adjunct instructor, and she still makes time for involvement in her community.

### Pulaski Technical College Doug Brown

Doug Brown, Emergency Management Coordinator for Arkansas Children’s Hospital, earned his associate degree at Pulaski Tech and completed baccalaureate and master’s degrees in emergency management and homeland security. He has received several awards for work on disasters, and his heroic works were featured in *USA Today* and *Advanced Rescue Technology*.

### Rich Mountain Community College Dr. Belinda Tedder

Dr. Belinda Tedder completed her associate degree at Rich Mountain Community College and went on to complete her baccalaureate degree in biology. She later earned a degree in Veterinary Medicine. Dr. Tedder states that she never regretted her decision to begin her postsecondary education at RMCC, and that RMCC prepared her well for the university level.

### South Arkansas Community College Charles Hazelwood

Charles Hazelwood is a graduate and former instructor at SouthArk, with associate degrees in medical laboratory technology and emergency medical technology-paramedic. He is a senior technician in quality control at a chemical company, and he is a reserve deputy sheriff and part-time paramedic. Charles goes above and beyond for others, insisting “This is how I can help.”

### Southeast Arkansas College

#### Joe Powell

Joe Powell is a consummate professional, known as the “fix-it man” for anything dealing with computers. He comes quickly to those in distress with a reassuring smile that everything will be all right when he finishes. And it is. Joe is not only a skilled professional, he has a heart as big as Arkansas.

### Southern Arkansas University Tech Randy M. Boren

Randy Boren is a 1978 graduate of SAU Tech. His accomplishments include working with the FAA developing Aging Aircraft Wiring Inspection Programs. Randy presently works for Lockheed Martin as Systems Engineer for the F-22 Raptor Program, and he writes the service manual for this highly superior fighter aircraft.

### University of Arkansas Community College at Batesville Julie Dayberry

Julie Dayberry completed an associate degree in education from the UA Community College at Batesville. She went on to complete her baccalaureate degree, graduating Magna Cum Laude, and she received the Outstanding Early Childhood Education Major award. Currently, Julie teaches first grade in Vilonia Schools.

### University of Arkansas Community College at Hope Clint Austin Bailey

The construction of Clint Bailey’s future started with a firm foundation of bricks and mortar. This associate degree graduate of UA Community College at Hope furthered his education in the field of architecture at the university level. Bailey is now employed by the Harris Architecture firm, designing three buildings on the UACCH campus.

### University of Arkansas Community College at Morrilton David Parker

David Parker’s positive “can-do” attitude helped him to succeed in earning an associate degree in retail marketing at UA Community College at Morrilton. David has recently accepted the position as general manager with Banana Republic. He continues to be an upbeat, confident leader as he encourages employees to achieve their own career goals.

## Academic All-Stars

### Arkansas Northeastern College Amber Flores

Amber Flores is an ESL (English as Second Language translator) for the Osceola School District, a single parent of two children, and a college student. She also volunteers as a translator for her local hospital, police department, and municipal court. Amber plans to complete a baccalaureate degree and become a Spanish teacher, and she has proven her drive to succeed by earning top grades while working and caring for her family. Amber says, "Study is the most important thing in our lives. We will always learn from life experiences and study the importance of the outcome of that life lesson."

### Arkansas State University-Beebe Denise M. Street

Denise M. Street plans to be a veterinarian. An accident, which badly injured her dog, helped her see her destiny. Determined to save her dog's leg, Denise researched treatments and applied knowledge she gained from volunteering at a vet clinic. Happily, her dog recovered fully. Denise is a member of Gamma Beta Phi, and she is in the Honors Program where she tutors students and helps with research papers. Denise is described as articulate, personable, and big hearted. She enjoys volunteering for various charities, her favorite being the Sunshine Rodeo which is designed for children with disabilities.

### Arkansas State University Mountain Home Zafer "Zaf" Ceto

Zafer "Zaf" Ceto's journey from Turkey to ASU Mountain Home covered more than 5,000 miles, and completing his associate degree is just the first leg of his academic journey. His long-range goals are to complete a baccalaureate degree in computer engineering and a master's degree in computer science. Zaf loves scuba diving, tennis, basketball, movies, and spending time with friends. Also, his application notes he helped his neighbors move out of their homes during a flood last year, made a movie about the flood, and gave copies to his neighbors to aid them in securing FEMA assistance.

### Arkansas State University-Newport Malerie Holley

Malerie Holley has experienced many fun and exciting times at ASU-Newport. One that particularly stands out was in her government class where her professor encouraged open discussion about controversial issues. She soon realized, "I have a voice, and I like to speak it." Malerie is an Ambassador and has been involved in the Leadership Class and volunteered in many activities sponsored by the Student Government Association. Malerie is described as focused, determined, committed, well-disciplined, and driven to achieve. Upon graduation from ASU-Newport, Malerie plans to complete a baccalaureate degree in Early Childhood Education.

### Black River Technical College Ashley M. Shimkus

Ashley M. Shimkus's dream to become a veterinarian has been influenced by several of her experiences that have taught her the values of responsibility, skill, dedication, and teamwork. She maintains a perfect 4.0 GPA and is described by her employer and instructors as "trustworthy, honest, dependable, innovative, and personable." Ashley says that her most meaningful educational experience was her recent induction into the Phi Theta Kappa honor society. When not in the classroom or at work, Ashley divides her time between volunteering at a local animal shelter and participating in a local bowling league.

### Cossatot Community College of the University of Arkansas Heather Fischer

Heather Fischer has worked diligently toward her degree by taking a full load not only during fall and spring terms, but summer terms, as well. She plans to complete her baccalaureate degree in early childhood education and become a preschool teacher. Heather stated in her essay: "Having a learning disability all my life has caused me to want to work even harder to prove to myself and those around me that having a disability should not discourage one from learning." Heather utilizes the resources that Cossatot provides and also offers assistance to her counterparts.

### East Arkansas Community College Franchie Scott

Franchie Scott expresses her perspective on education through her own words: "I have learned that it is important to receive an adequate amount of education in order to be successful in life." While pursuing a nursing degree at EastArk, she has logged countless hours working with children at her local pre-school, distributing food and clothing at her church, and devoting her time as both a mother and a minister's wife. Franchie's instructors describe her as an outstanding, exceptional, and highly motivated student who demonstrates a hunger to grow academically, intellectually, and personally.

### Mid-South Community College Christopher Sherrill

Christopher Sherrill was home-schooled, took concurrent classes at Mid-South, and is now working toward an associate degree. He is the President of the Baptist Student Association, a community volunteer, and an active volunteer for his church. Christopher says, "Faith is very important to me. My goals need to be completely Christ-centered. By completing my education, I will have a trade that will be of value in the mission field or when I come home." Comments about Christopher reveal that he "is one of those students who remind you exactly why you decided to pursue a career in higher education."

## Academic All-Stars

### National Park Community College Brittany Bailey

Brittany Bailey's goal has always been to become a nurse. While a student at National Park, she has balanced a demanding academic schedule with a full time summer position as a lifeguard to assist in financing her education. Described by her instructors and her employer as intelligent and compassionate, Brittany presents both creative and innovative ideas in the classroom and the work place. Her hospital clinical experience has been the most meaningful to her so far. There she has learned that "the best nurses are those that initially want to help and take care of people who are ill or hurt."

### North Arkansas College Evan Robinson

Evan Robinson is a model scholar-athlete at NorthArk. Described by his instructors as a natural leader, he consistently demonstrates his ability to influence those he interacts with in the classroom, on the basketball court, and in his community. Evan's interests include coaching youth basketball camps, tutoring fellow students, and assisting with environmental clean-ups in his community. According to Evan, his most meaningful educational experience was leading a debate team during his Honors Composition class. During this experience, he developed skills which will enable him to interact well with others as he pursues his goal of becoming a physical therapist.

### NorthWest Arkansas Community College Robert Lovejoy

Robert Lovejoy never dreamed that an injury in the line of duty would forever change the course of his life. Not only did he find his way to NWACC, he has used his skills as a firefighter and paramedic to enhance the lives of his fellow students, instructors, and community members. Robert is President of Students in Free Enterprise (SIFE). He also served honorably with the United States Marine Corp, learning the basics of commitment, dedication, integrity, and leadership, which have greatly influenced his academic achievement. His goal is to complete his baccalaureate degree in marketing management.

### Ouachita Technical College Robert Ellerd

Robert Ellerd gave himself a second chance. When faced with an opportunity to continue his education and given information that made it seem possible, he embraced the chance and moved forward. In his essay Robert says, "I realized that a college degree was not out of reach- simply above the low expectations I had set for myself." He proves his dedication to his educational path by being an excellent student, a productive work-study, and President of the Student Government Association. Robert plans to complete his baccalaureate degree and teach at a two-year college.

### Ozarka College Jessica Wolford

Jessica Wolford is a cancer survivor and a single mother who works hard to support her daughter and succeed in college. Jessica is working toward an associate degree in applied technology and plans to major in journalism. She says that her "enjoyment in life will come from giving back to a community and school that has done everything they could" for her. Jessica is involved in Phi Theta Kappa, Career Pathways, TRIO, and Relay for Life. She has proven her community dedication by helping to organize "Christmas for Kaylee" to help a local family through a holiday time accident.

### Phillips Community College of the University of Arkansas Brenda F. Carter

Brenda F. Carter is a nontraditional student in the truest sense, balancing the roles of student, parent, and business owner. She returned to school after 30 years to pursue her goal of becoming a registered nurse. Brenda says: "All of my instructors and fellow students have contributed to my learning experience. Being at a two-year college has the advantage of being able to know everyone and to encourage all to 'hang in there'." Brenda is a member of Phi Theta Kappa, an anatomy and physiology tutor, and her class secretary/treasurer.

### Pulaski Technical College Lydia Moore

Lydia Moore is praised by her instructors as the "finest example of what Pulaski Tech is all about." She is a dedicated student, a devoted full-time mother, and editor of the school journal. Her dream to complete her degree in English and creative writing was almost lost until she found her way to Pulaski Tech. According to Lydia, "It's funny in life how sometimes the places you end up are exactly the places you need to be." Lydia credits Pulaski Tech with giving her the power to fulfill every hope, dream, and ambition that she has ever even thought to have.

### Rich Mountain Community College Andrea Hughes

Andrea Hughes has devoted her life to serving others. She is described as an exemplary student who is personally committed to her family, her community, and Rich Mountain Community College. Whether serving as a volunteer firefighter and first responder, devoting herself as a wife and mother, or immersing herself in the President's Leadership Council or the Student Government Association, Andrea always gives 110%. Through her coursework, she has learned the value of interaction with others, facing fears, and experience. Upon completion of her degree in occupational therapy, she hopes to return to her hometown, where she can continue her tradition of service to others.

## Academic All-Stars

### South Arkansas Community College Marla J. Benson

Marla J. Benson came to South Ark following the closing of the plant she worked in for twenty-one years. Hesitant to return to school, Marla feared she would not succeed. Marla has maintained a 4.0 grade average and says “I no longer set myself up for failure; Instead I can see successes from all angles.” Marla is described as “pleasant, intelligent, efficient, dependable, and always helpful to others.” Her most meaningful educational experience came after becoming a member of Phi Beta Lambda, competing in the State Leadership Conference and winning in three divisions.

### Southeast Arkansas College Kirb “Ed” Silvey

Kirb “Ed” Silvey is dedicated to both his career and his academic studies. In addition to his full-time job, he is Vice President of Phi Theta Kappa, a Student Ambassador, and member of the Student Senate. Speaking to the Manufacturing Council (who provided him with scholarships), Ed detailed his academic goals, achievements, and involvement in student activities. The Manufacturing Council could see how well their money was being invested in changing lives, one student at a time. Following Ed’s presentation, the Council quickly passed a resolution extending their scholarship for another three semesters.

### Southern Arkansas University Tech Paulina Curbelo

Paulina Curbelo plans to complete her associate degree at SAU Tech, and then complete a baccalaureate degree in fine arts with an emphasis on graphic design. She states that she feels she made “the perfect choice by earning my technical certificate in the graphic design program.” Paulina has made the Chancellor’s List and the Dean’s List, worked through the Federal Work Study program, and even helped on recruiting trips. She has already applied the skills she has learned in the Graphic Design program by designing logos, business cards, flyers and t-shirts for many college and community organizations.

### University of Arkansas Community College at Batesville Shelby N. Dunaway

Shelby N. Dunaway was named to the Dean’s and Chancellor’s lists during her freshman year. She participates in the Student Government Association as parliamentarian, Phi Theta Kappa, and volunteers for many campus activities. Shelby also served as the first student chair of the UACCB Performing Arts and Lecture committee, planning and successfully executing a full menu of performances. Shelby cites a Round Table book discussion as her most meaningful educational experience because it provided her and others “the chance to read a controversial book, discuss and share their thoughts on the book and gain knowledge and insights into different cultures.”

### University of Arkansas Community College at Hope Jennifer Martinez

Jennifer Martinez is a motivated student who exhibits excellent leadership abilities. She is the wife of a soldier, a mother of three daughters, and a photographer. She plans to use her business degree to make her photography business more successful. Jennifer has learned that the most important “pat on the back” is from herself, and understanding that she is the key player in her success has helped her surpass her own expectations. Jennifer is an inspiration to others and has proven that “if you work hard enough and refuse to make excuses for yourself, you can truly accomplish anything.”

### University of Arkansas Community College at Morrilton Vicki Shadell

Vicki Shadell’s says, “I came to realize that if I was going to have any credibility with my children or my 4-H kids, I had to find a way to go back to school to earn my degree.” Vicki is not only an excellent and involved student, but she is also a parent and a community volunteer. She has been instrumental in establishing a county-wide recycling program through her 4-H work that has led to the “soon to be built” county recycling facility funded by grants and other organizations.

# Hot Springs Convention Center

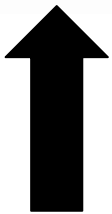
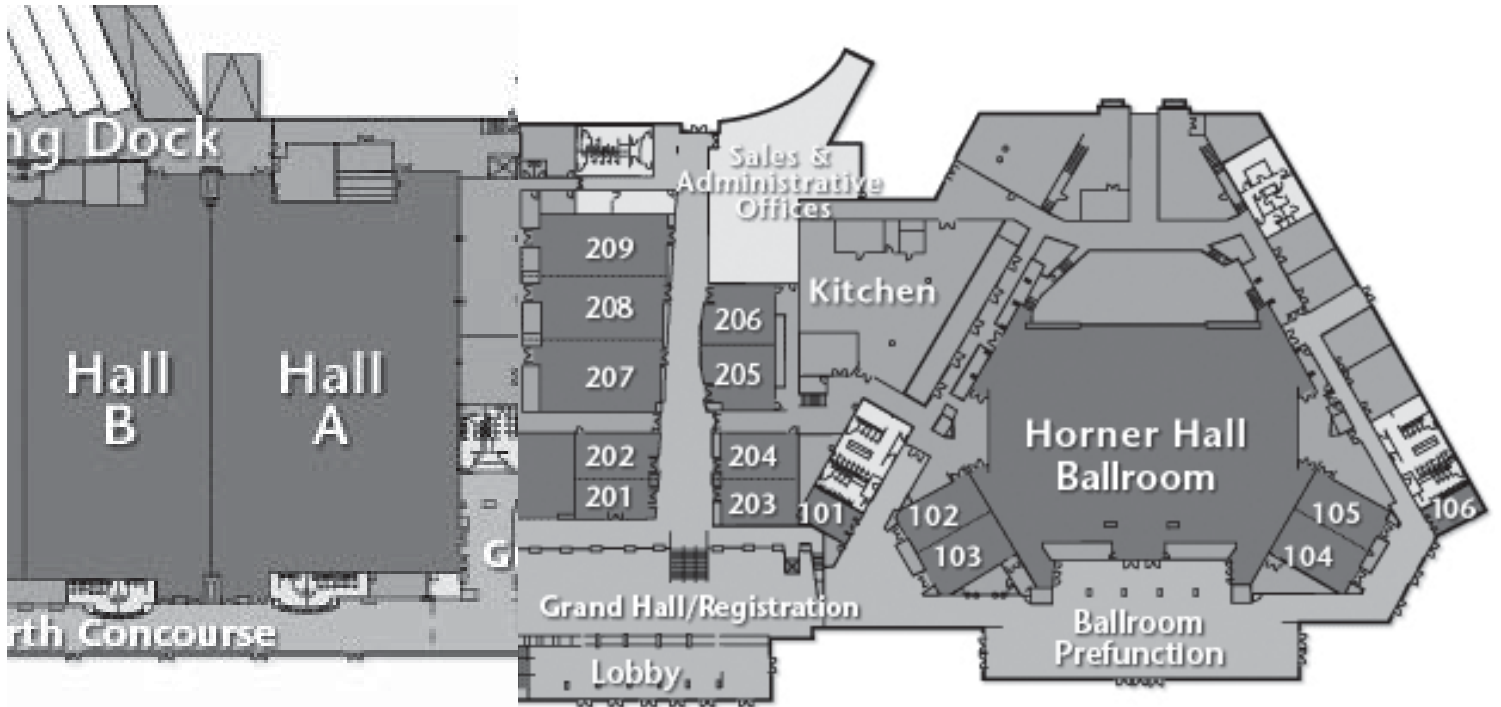

**Rooms B1, B2, B3, B4**

# Special Thanks to our Sponsors and Exhibitors

<b>Booth</b>	<b>Sponsor / Exhibitor</b>	<b>Booth</b>	<b>Sponsor / Exhibitor</b>
33,34	AATYC	23	Kendall Hunt Publishing Company
63, 64, 65	Academic All-Stars Auction	12	KUDER, INC.
14	Alliant Data Systems, Inc.	29,30	Lee Wayne Corporation
56	American Fidelity Assurance Company	25	Magee Enterprises
37	AATYC Aerospace Consortium	53	Medical Education Technologies, Inc.
15,16	Arkansas Capital Corporation	46	Missco Contract Sales
66	Arkansas Correctional Industry	6	Nabholz Construction
2, 3	Arkansas Department of Career Education	54	NCCER/Pearson
49, 50	Arkansas Department of Higher Education	21	ORACLE
43	Arkansas Federal Credit Union	44	Pearson Learning Solutions
61	Arkansas Scholastic Press	24	PLATO Learning, Inc.
10	Arkansas State Chamber of Commerce/ AIA	38	Presidium, Inc.
11	Arkansas State University-Jonesboro	45	Spectrum Industries, Inc.
39	Arkansas Student Loan Authority	7	Strayer University
9	Arkansas Tech University	13	Student Financial Lab
22	Blackboard, Inc.	8	Synch-Solutions
48	Boston Reed College	36	THE HODGE GROUP
26	Business Communication Coaching Group (BCCG) LLC	47	UAMS/College of Health Related Professions
60	Capsearch	20	University of Arkansas Global Campus
59	Career Step	41	University of Arkansas-Fort Smith
32	Curtis Stout	58	University of Arkansas at Monticello
35	Datatel	27	University of Central Arkansas
42	DEPCO, LLC	18	VALIC
51	EAST-HARDING, INC.	62	Valley Services, Inc.
5	Educational Opportunity Center- Henderson State University	57	VIRCO, INC.
31	Educational Systems Products	19	Wimba
1	ERJ ASSOCIATES	17	Wittenberg, Delony & Davidson, Inc. Architects
4	Harris Architecture Company		Arkansas Broadcasters Association
28	Hill & Cox Corporation		Augusoft (information in conference packet)
52	H-ITT		National Association for Community College Entrepreneurship, Inc. (NACCE)
55	Howard Technology Solutions		Nuventive (information in conference packet)
40	I CAN Learn Education Systems		

Blue denotes CONFERENCE SPONSORS

# GOLD Sponsors



# BRONZE Sponsors



# PROGRAM Sponsors



"Arkansas" Higher Education Marketing Leader"

